

Sign Permit Application

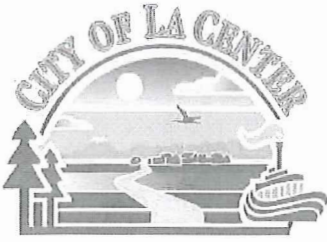

City of La Center, Planning Services
305 NW Pacific Highway
La Center, WA 98629
www.ci.lacenter.wa.us
Ph. 360.263.7665 Fax: 360.263.7666
www.ci.lacenter.wa.us

Permit Type: Banner Monument Temporary Commercial Residential Other

Legal Property Owner: ERIC & TANDY STENBERG Phone: 360 909-1599

Address: 209 E 4th St. LaCenter, WA Email: stanchillcoffeehouse@comcast.net

Applicant (if different from owner): _____ Phone: _____

Address: _____ Email: _____

Sign Installer: OWNER Phone: _____

Date Sign Installed: TBA Date Sign To Be Removed: PERMANENT

Sign Location: FRONT RIGHT LAWN of House / Business

Sign Dimensions: Height: 3' Width: 3' SQ. Ft. Total: 9 Illuminated N/A

Additional Documentation As Needed Demonstrating Compliance with LCMC 8.60

- Sign Design (Scaled drawings showing height, width, area, color, illumination and number and location of proposed signs.)
- Site Plan (Documenting existing signs, setbacks and/or facade dimensions.)
- Landscaping Plan (if required)
- Lighting Plan (if required)

Property Owner Signature [Signature] Date 8.30.2022

Applicant Signature [Signature] Date 8.30.2022

Office Use Only

Permit # 2022-032-SIGN Fees: \$ 60.00

Received By JLN Date Paid: 8/31/2022

Date Received: 8/30/2022 Receipt # 01754084

Date Approved: _____ Procedure: Type I
Type II
Type III

Zoning Designation: C-1

Notes downtown overlay district

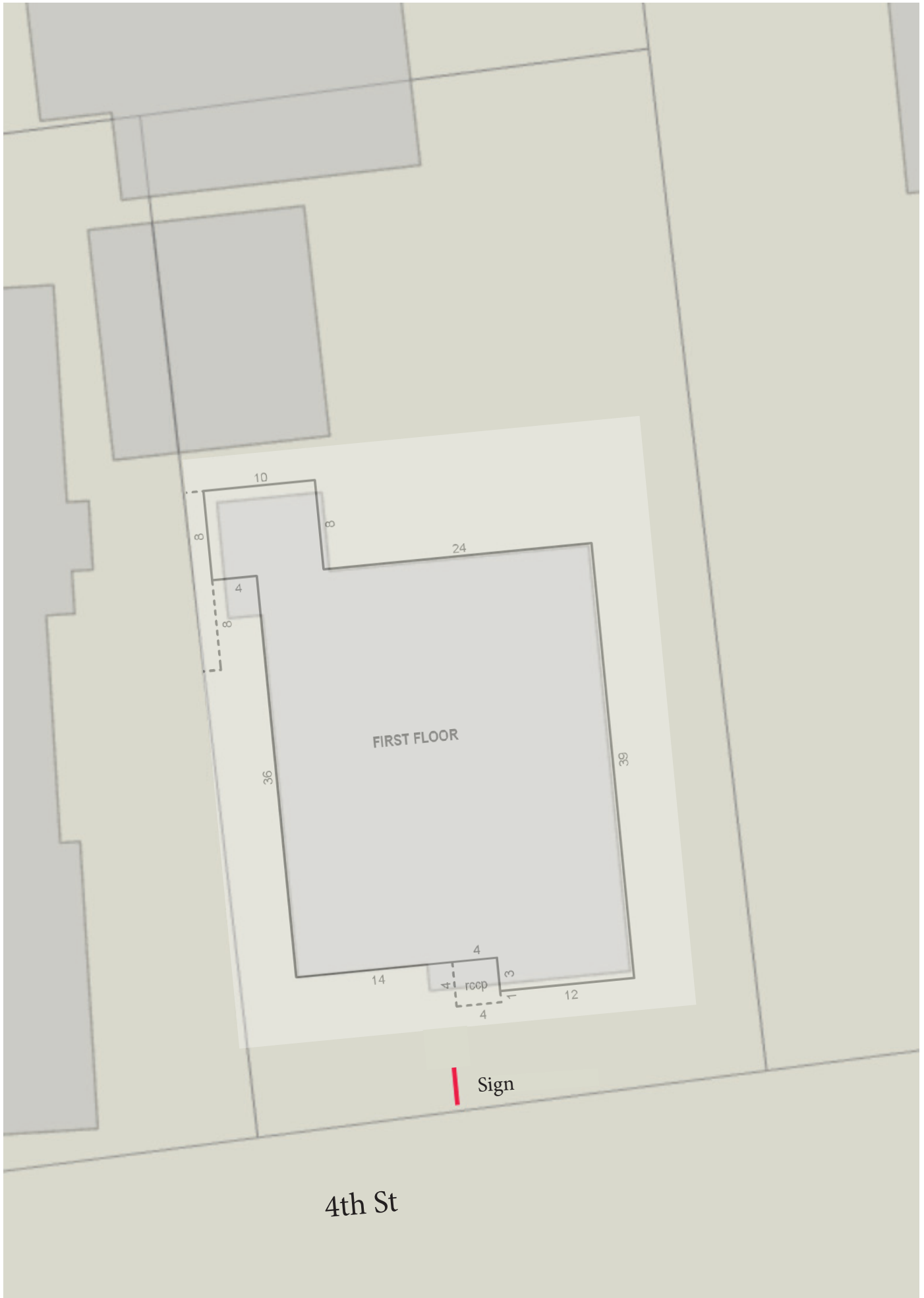

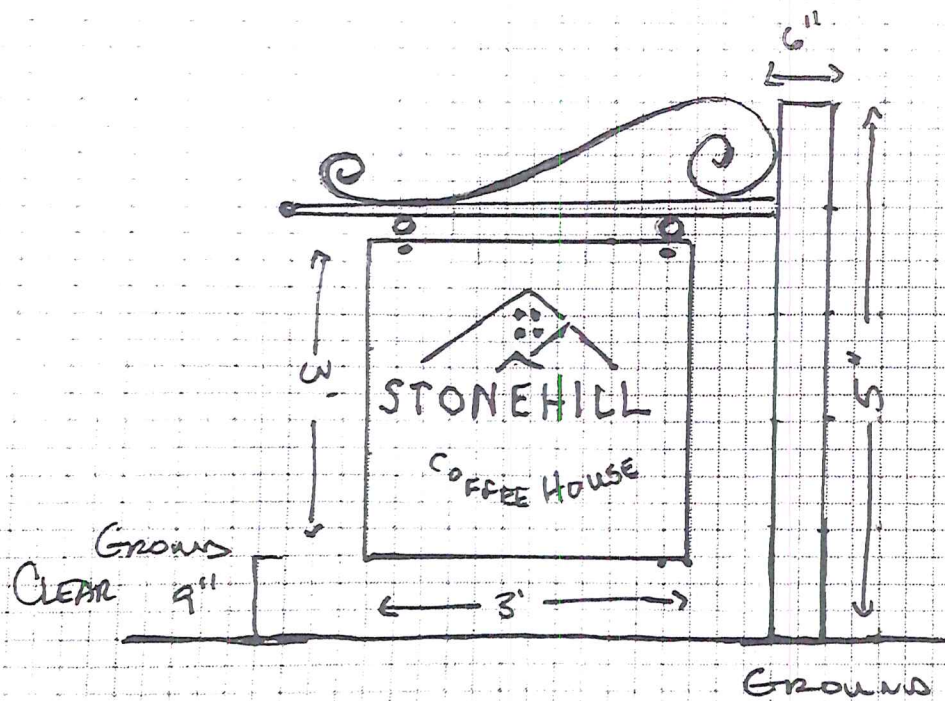

MATERIAL FOR POST.

METAL POST

3" x 9' BURIED 4' / CEMENTED IN
COVERED WITH 3/4" x 5 1/2" SMOOTH PINE

NOT TO SCALE

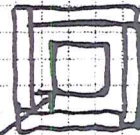

TOP VIEW

GAP BETWEEN FILLED WITH CEMENT
POST + WOOD

