



VICINITY MAP



SITE DATA:

TAX LOTS: TAX LOTS #8, #151 & #153 SE 1/4 SEC 33 T5N R1EWM
 QUARTER SECTION: SE 1/4 OF SEC. 33, T5N R1E, W.M.
 SERIAL NUMBER: 258766000, 258768000 & 258631000
 SITE ADDRESS: 34100 & 34214 NW PACIFIC HWY, LA CENTER, 98629
 AREA: 9.43 ACRES OR 410,768 SQ FT
 ZONING: R-12 WITH UH-10 OVERLAY
 COMPREHENSIVE PLAN DESIGNATION: URBAN HOLDING

LEGEND:

- INDICATES BOUNDARY
- INDICATES ADJUSTED PROPERTY LINE
- INDICATES EXISTING PROPERTY LINE
- INDICATES GAS LINE
- INDICATES WATER LINE
- INDICATES OVER HEAD POWER & PHONE
- INDICATES SEPTIC SYSTEM LID

| LOT AREA TABLE | | |
|----------------|------------------|------------------|
| T.L. # | EXISTING ACERAGE | PROPOSED ACERAGE |
| 8 | 4.31 | 3.96 |
| 151 | 4.46 | 4.65 |
| 153 | 0.66 | 0.82 |

| LINE TABLE | | |
|------------|---------------|----------|
| LINE | BEARING | DISTANCE |
| L1 | S 43°28'56" E | 15.05' |
| L2 | N 46°31'04" E | 20.00' |
| L3 | N 46°31'04" E | 20.00' |

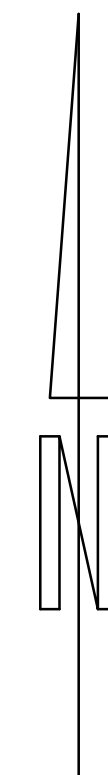

OWNER/APPLICANT:
 RODNEY PETERSON
 PO BOX 176
 LA CENTER WA, 98629
 360-263-3353
 rodman@tds.net

APPLICANT'S REPRESENTATIVE:
 CHRIS AVERY
 MINISTER & GLAESER SURVEYING
 2200 E EVERGREEN BLVD.
 VANCOUVER, WA 98661
 360-694-3313 FAX 360-694-8410
 csa@mgsurvey.com

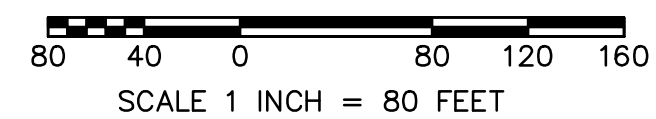

MINISTER-GLAESER
 SURVEYING INC.
 2200 E EVERGREEN BLVD.
 VANCOUVER, WA 98661
 (360) 694-3313

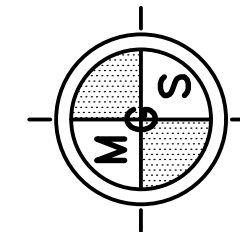

SITE PLAN FOR:

PETERSON B.L.A.

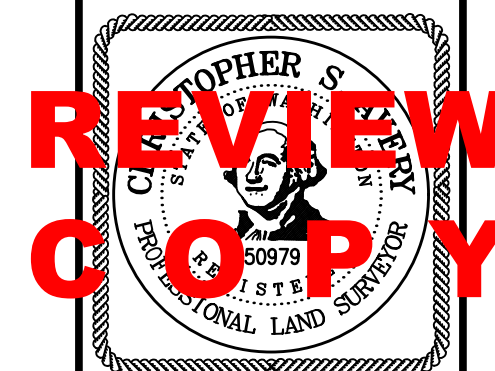

REVIEW COPY

JOB #: 18-434

FILE: 18434PR1

DATE: 02/10/20

DRAWN BY: CSA

SHEET 1 OF 1