

**MINISTER-GLAESER
SURVEYING INC.**

*Vancouver Office – 2200 E. Evergreen Blvd., Vancouver, Washington 98661
(360) 694-3313 (360) 694-8410 FAX
Pasco Office – 6303 Burden Blvd, Suite E, Pasco, Washington 99301
(509) 544-7802 (509) 544-7862 FAX*

October 13, 2020

**PERIMETER DESCRIPTION
FOR
HIGHLAND TERRACE PHASE 1**

A portion of the Southeast quarter of Section 33, Township 5 North, Range 1 East, Willamette Meridian, City of La Center, Clark County, Washington, described as follows:

BEGINNING at a 1/2-inch iron rod marking the East quarter corner of said Section 33 as shown in Book 31 of Surveys, Page 161, Clark County Auditor's Records and described in Book 5 of Land Corner Records, Page 50;

Thence North $88^{\circ} 42'02''$ West along the North line of the Southeast quarter of Section 33, for a distance of 1060.01 feet to the **TRUE POINT OF BEGINNING**;

Thence continuing North $88^{\circ} 42'02''$ West along said North line for a distance of 601.87 feet;

Thence leaving said North line South $02^{\circ} 01'29''$ West, for a distance of 28.90 feet to a 1/2-inch iron rod set in Book 14 of Surveys, Page 43;

Thence continuing South $02^{\circ} 01'29''$ West, for a distance of 1031.79 feet to a 1/2-inch iron rod set in said Survey (ROS 14-43);

Thence continuing South $02^{\circ} 01'29''$ West, for a distance of 15.53 to the Northeasterly Right-of-way line of Northwest Pacific Highway;

Thence Southeasterly along said Northeasterly Right-of-way line South $37^{\circ} 31'56''$ East, for a distance of 392.68 feet;

Thence along the arc of a 2835.00-foot radius curve to the left, through a central angle of $5^{\circ} 57'00''$, for an arc distance of 294.41 feet;

Thence South $43^{\circ} 28'56''$ East, for a distance of 223.80 feet;

Thence North $46^{\circ} 31'04''$ East, for a distance of 20.00 feet;

Thence South 43° 28'56" East, for a distance of 236.96 feet;

Thence leaving said Northeasterly Right-of-way line North 41° 41'49" East, for a distance of 289.37 feet to a 1/2-inch iron rod with a yellow plastic cap set in Book 31 of Surveys, Page 161;

Thence South 87° 39'18" East, for a distance of 151.28 feet to a 1/2-inch iron rod with a yellow plastic cap set in said Survey;

Thence North 02° 10'19" East, for a distance of 416.38 feet to a 1/2-inch iron rod with a yellow plastic cap set in said Survey;

Thence North 88° 41'31" West, for a distance of 401.58 feet to a 1/2-inch iron rod with a yellow plastic cap set in said Survey;

Thence North 02° 01'55" East, for a distance of 131.14 feet to a 1/2-inch iron rod with a yellow plastic cap set in said Survey;

Thence North 88° 40'18" West, for a distance of 125.05 feet to a 1/2-inch iron rod with a yellow plastic cap set in said Survey;

Thence North 02° 00'19" East, for a distance of 1119.04 feet to a 1/2-inch iron rod with a yellow plastic cap set in said Survey;

Thence continuing North 02° 00'19" East, for a distance of 30.19 feet to the **TRUE POINT OF BEGINNING.**

EXCEPT the following described parcel of land:

BEGINNING at the most Westerly Northwest corner of the above described parcel;

Thence South 02° 01'29" West along the West line of said parcel for a distance of 723.67 feet;

Thence leaving said West line South 88° 40'38" East for a distance of 362.50 feet;

Thence South 04° 21'28" West , for a distance of 12.65 feet to the **TRUE POINT OF BEGINNING** of said exception parcel of land;

Thence North 87° 57'49" West, for a distance of 206.48 feet;

Thence South 03° 05'02" East, for a distance of 118.86 feet;

Thence South 80° 57'03" East, for a distance of 185.09 feet;

Thence North 06° 58'07" East, for a distance of 141.51 feet to the **TRUE POINT OF BEGINNING.**

EXCEPT Public Roads.

CONTAINS 25.60 acres of land, more or less.

Together with and subject to easements, restrictions, covenants, dedications and reservations apparent or of record.

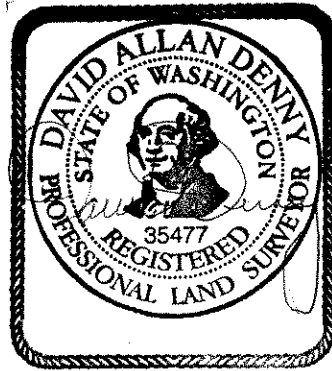

10-14-20