

2 COLUMNS ARE 8X8X16 CMV
MIDDLE SUSPENDED SIGN USES 6X8X16 CMV
GROUT SOLID COLUMNS

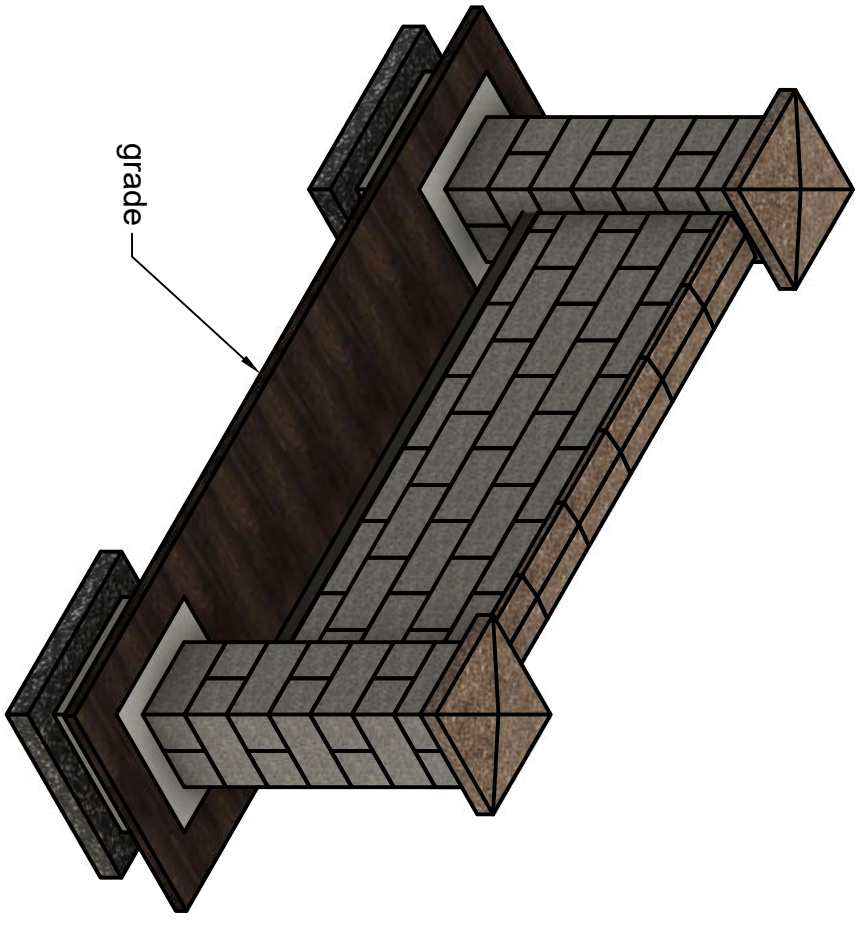

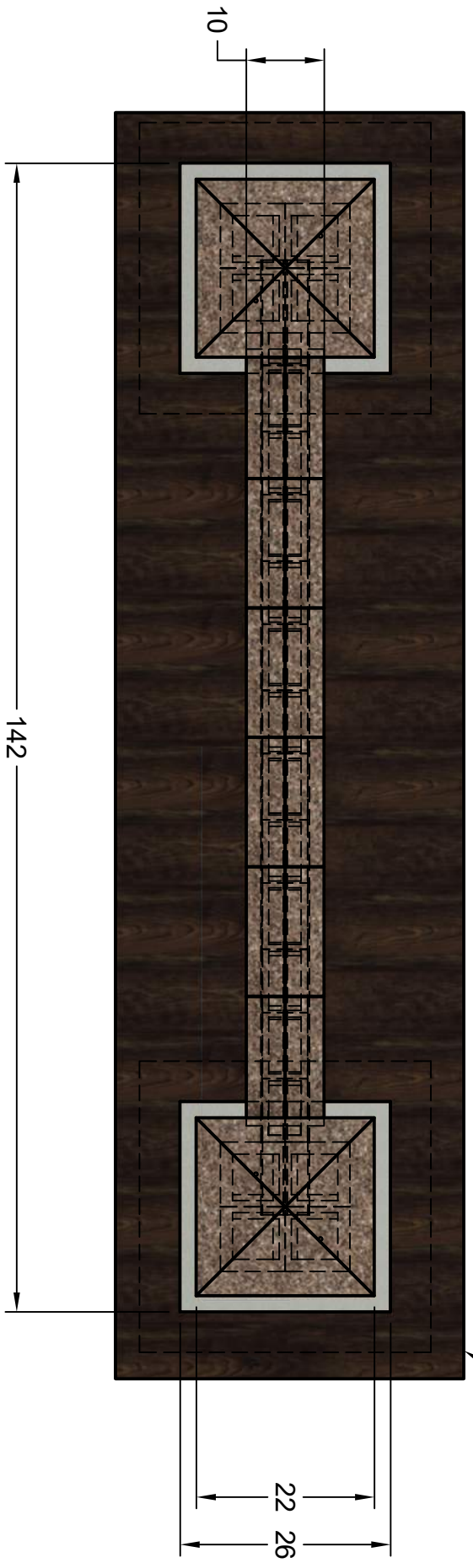
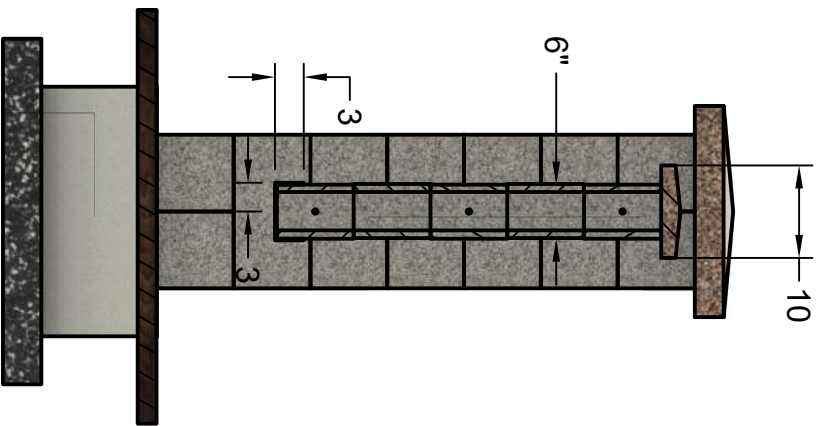

SECTION A-A
SCALE 1:20

- 2 COLUMNS ARE 8X8X16 CMV
- MIDDLE SUSPENDED SIGN USES 6X8X16 CMV
- GROUT SOLID COLUMNS

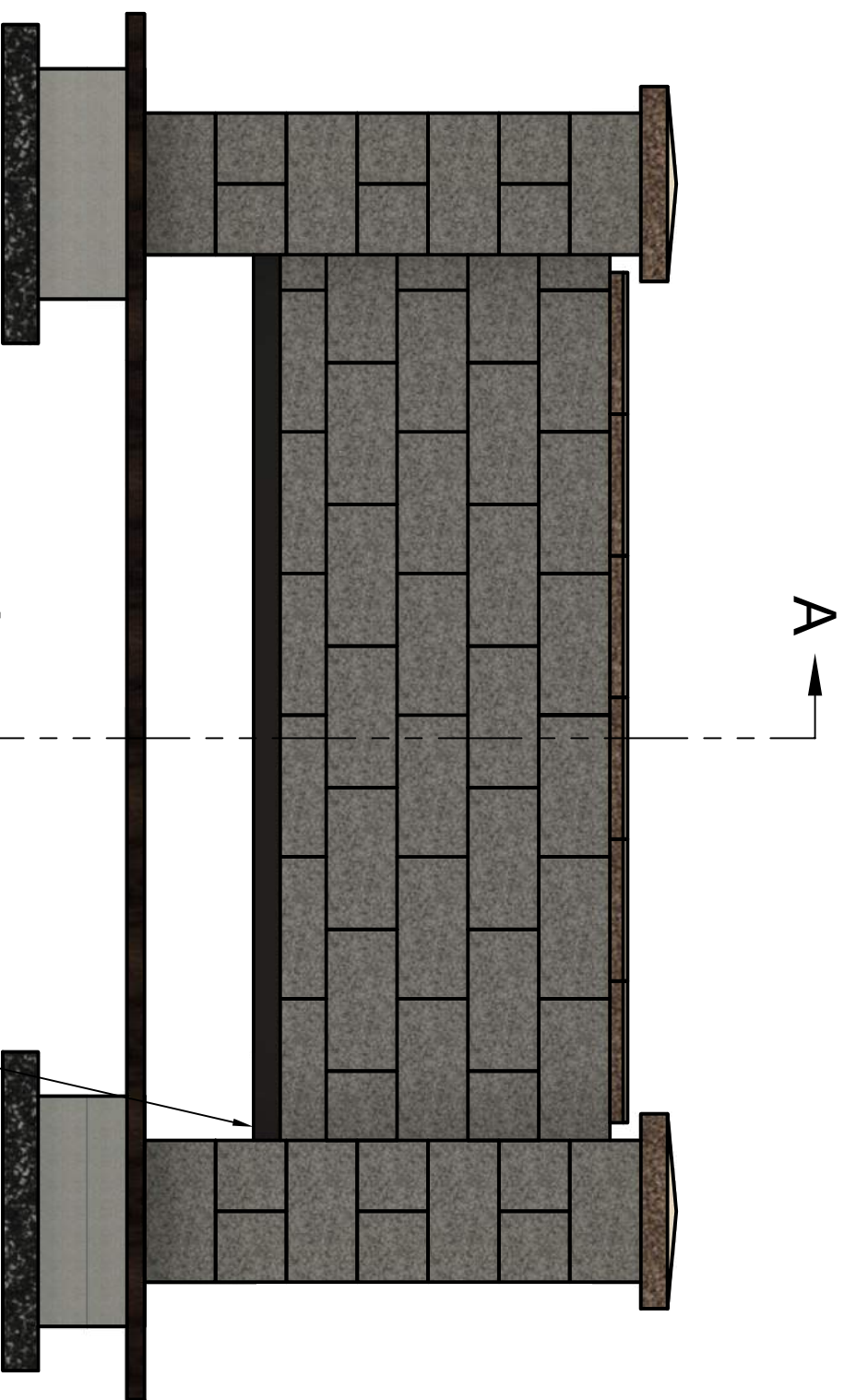

There are two 3"x3"x $\frac{3}{16}$ " metal angle iron at bottom of conderblocks



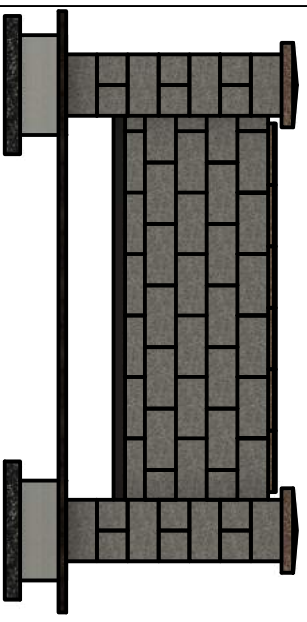

REBAR INSIDE CINDER BLOCKS
ALL #4 BAR

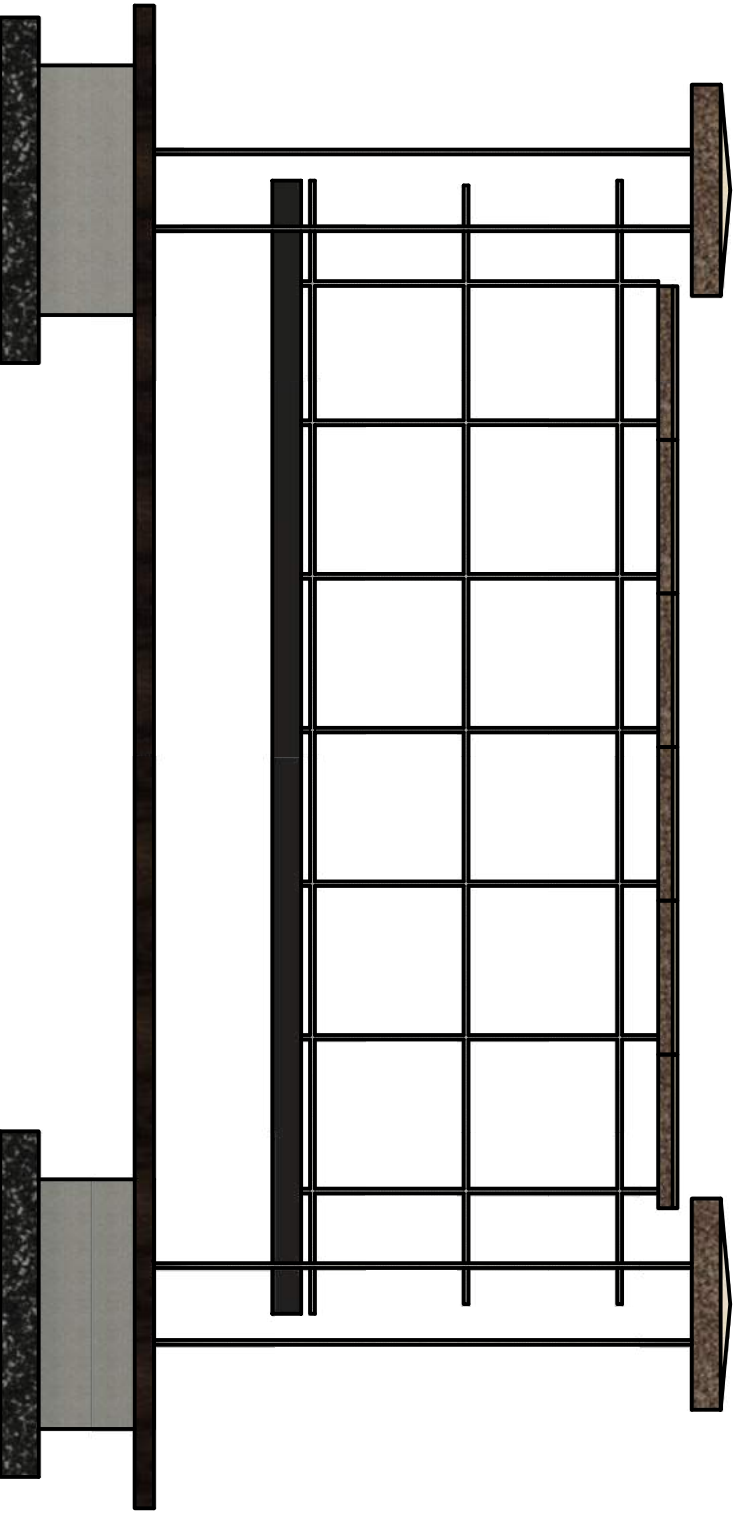
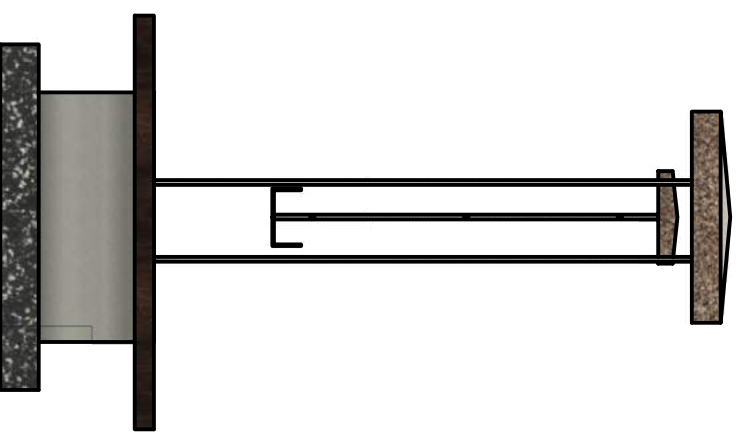
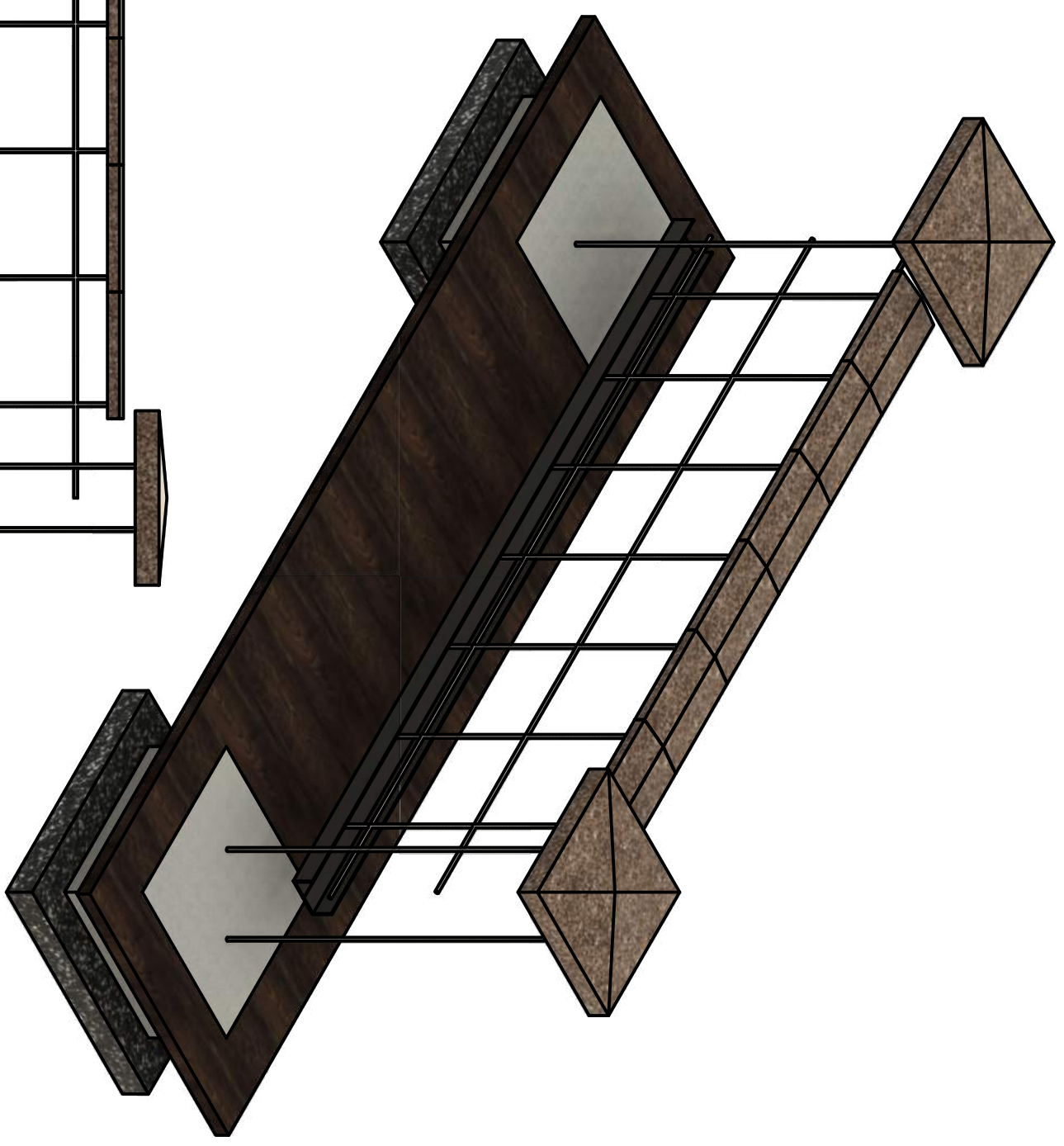



2 - 3" x 3" x 3/16" rebar to span bottom coarse vertical and horizontal #4 bar (grouted every 16") 16" on center

2 vertical sticks #4 bar per column tied to footing (columns grouted solid)

* columns built of 8x8x16 CMU

* suspended sign backing 6x8x16 CMU