

Table of Contents

Pg. #	Title
1-2	Table of Contents
3-6	Narrative Synopsis
7	Dimensions & North Arrow
8	Dimensions & North Arrow
9	Site Boundary
10	Proposed Name of Project
11	Vicinity Map-LCHS Campus & Surrounding Areas
12	Vicinity Map-LCHS Campus
13	Vicinity Map-LC Garden w/ GreenShed
14	Configuration-overview
15-18	Drainage System
19	Configuration-topo (zoomable)
20	Dimensions-overview
21	Existing and Proposed Buildings & Structures
22	Proposed Uses for Building & Structures-GreenShed
23	Sided & Un-sided Views from North
24	Skeleton Finished NE View
25	Gutter on Shed
26	Gutter
27	Skeleton Finished-West View
28	Door Railing (West & East)
29	Internal Header Installment and Rails
30	Service Door Placement
31	Rain Barrel Addition
32	Finishing of Perlongs

33	Continuation of Perlongs Build
34	Overhang Rebuild #1
35	Truss Build #1
36	Truss Rebuild #1
37	Ariel w/ posts noted
38	Northern View w/ Lumber
39	Western View w/ Lumber
40	Southern View w/ Lumber
41	Eastern View w/ Lumber
42	Walls & Fences- Locations
43	Walls & Fences- Heights and Construction Material
44	Eco Block Wall Diagrams
45	General Location & Configuration of Landscape> LCHS Campus & Surrounding Area
46	LCHS Campus & LC Garden
47	General Location & Configuration of Proposed Landscape> La Center Garden
48	Existing Exterior Lighting
49	Off-Street Parking and Loading Facilities
50	Name and Location & Width of Existing & Proposed On-Site Streets & Roadway Easements
51	Location & Width of Existing & Proposed On-Site Pedestrian & Bicycle Facilities
52	Gravel Trail Plan for LC Garden
53	Existing & Proposed Public
54	Utility Plan for LC Garden
55	Utility Conduit - East and Center
56	Garden Boundaries

The La Center GreenShed: An Addition to the La Center Garden **Narrative Synopsis**

History

The vision for the La Center High School GreenShed started during the 2016/2017 school year, as an element of a project that students created for the Imagine Tomorrow Competition, an annual 4-state event for high school students, which is focused upon environmentally sustainable innovations. The intention behind the GreenShed was to create a more environmentally sustainable approach to a typical garden shed intended for housing garden tools and equipment. It would still serve as storage, but would also put into practice a number of environmentally sustainable components, allowing it to serve as an educational feature in the in-progress La Center Garden and Outdoor Learning Space.

The La Center Garden was first envisioned by La Center students and educators in 2014, with plans drafted during the 2015/2016 School Year. It was the focal point of the team's Imagine Tomorrow Competition innovation and was central to certifying as a platinum level Washington Green School. Plans were drafted by Mr. Anthony Cooper through the City of La Center in the spring of 2016, permits were processed with the coordination of the La Center Education Foundation's Josh Soske, and construction of the site's infrastructure was completed during the summer of 2016. The next phase of the La Center Garden and Outdoor Learning Space is our proposed GreenShed.

Changes to the site

The change we are proposing is the removal of 3-4 inches of sod to create a level foundation area upon which to construct the shed. Compacted gravel will then be used as a foundation under and around the 12 ft. x 24 ft. shed. The gravel foundation will measure 22.5 feet North to South by 42 feet East to West.

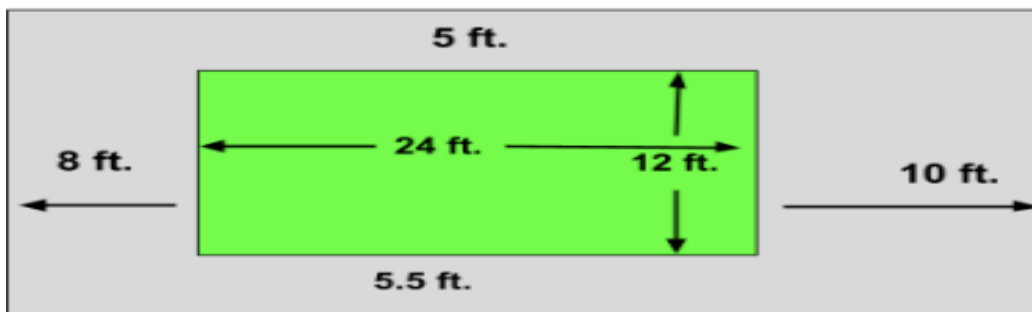

Gray: Gravel pad extended around GreenShed
Green: Actual GreenShed building

Changes to Structures

We are solely seeking to obtain a building permit to construct the 12 foot x 24 foot, shed on a 22.5 x 42 ft leveled gravel pad.

Changes to Landscaping

Our initial plan for the proposed GreenShed includes laying a gravel pad (see above) upon which we shall construct the shed. We also intend to install a rain garden southeast of the shed to aid with drainage and erosion mitigation.

Changes to Lighting

The current lighting in the adjacent parking lot along the southern end of the La Center Garden and that within the La Center High School Track, Field, and Stadium to the north will suffice. We will work with Clark PUD to install solar panels with their contracted solar construction company who will process all necessary permits for that later-intended addition to our GreenShed.

Changes to Parking:

The City of La Center parking lot, along the southern border of La Center High School Campus and directly below the La Center Garden, may serve as adequate parking for the La Center Garden and our proposed GreenShed.

Use:

The intended use of the GreenShed is to provide storage for our La Center Garden and outdoor classroom, while modeling sustainable land use, waste reduction, watershed awareness, and clean energy production to La Center students in our schools, residents and visitors to our town. This will be a benefit to students in the La Center Schools and our community.

Utility:

Our initial plan is to simply construct a 12 foot x 24 ft storage shed with no connection to public or private utilities.

Frontage:

The proposed GreenShed is to be situated within the northeastern area of the La Center Garden. This is to the north of the parking lot used during the day by La Center High

LC GreenShed - Narrative Synopsis Cont.

School, but owned by the City of La Center. That parking lot, along with the La Center Garden and proposed GreenShed to the north, is across 4th Street from Holley Park. 4th Street is the main road running east to west through the incorporated city of La Center. It is along 4th Street, into the parking lot, and through access gates that visitors will access the La Center Garden and the proposed GreenShed within it. Students from the High School will typically access the LC Garden and GreenShed through the gate in the northwest area of the La Center Garden. That gate opens into the La Center Garden from the La Center High School Track, Field, and Stadium. As per the recommendation of the Clark Cowlitz Fire and Rescue Deputy and the CCFR Inspector, an additional service gate will be installed along the southern fenceline to more rapidly allow first responders to access the area upon which the GreenShed is to be constructed.

Transportation:

The typical mode of transportation to the proposed GreenShed and around the La Center Garden will be on foot- walking. The ADA trail that runs the length of the garden from north to south accommodates wheelchair users. The trail may be accessed from the north through a delivery gate or from the south through either a service or delivery gate. As the slope in the LC Garden is less than 5% from the ADA trail east toward the GreenShed, it will be accessible as well.

Periodically, supplies and equipment will be delivered to the GreenShed using the southern delivery gate and driveway from the lower parking lot or by using the service gate near the La Center High School Track, Field, and Stadium in the northwest portion of the La Center Garden. When transporting materials to or exporting materials and supplies from the GreenShed, we will use the school district's Gator, golf cart or a small truck. The north and south access points were designed and permitted in 2016, for periodic vehicular use.

Additional information

The diagram inserted below is a copy of the one made for the 2016 construction of the La Center Garden. Two access points are intended to be added during the construction of our proposed La Center GreenShed, one along the eastern fence line to allow for an ADA pathway to connect directly from the current walkway from the lower parking lot to the HS Campus, an another in the eastern portion of the southern fence line to allow direct access from 1st responders parked in the lower parking lot to the GreenShed. [Please note the change to the location of the GreenShed, previously noted as the "Garden shed and locker pad".]

LC GreenShed - Narrative Synopsis Cont.

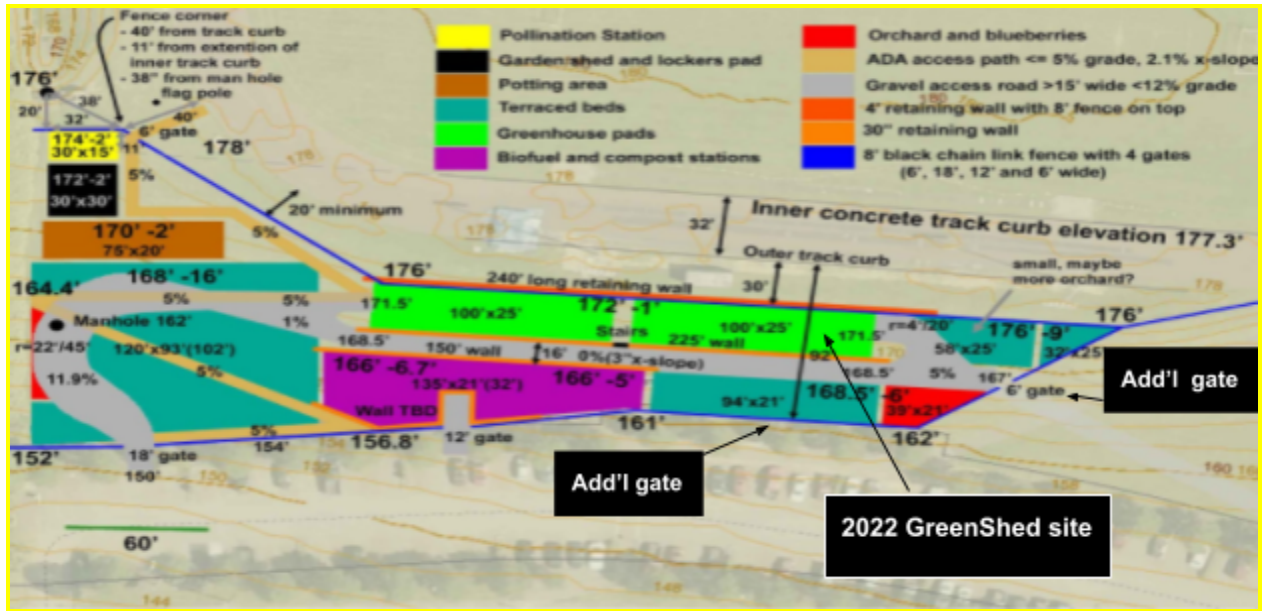

2016 La Center Garden Design with 2022 GreenShed and two additional gates noted

#1-1: Dimensions & North Arrow
Southwestern view

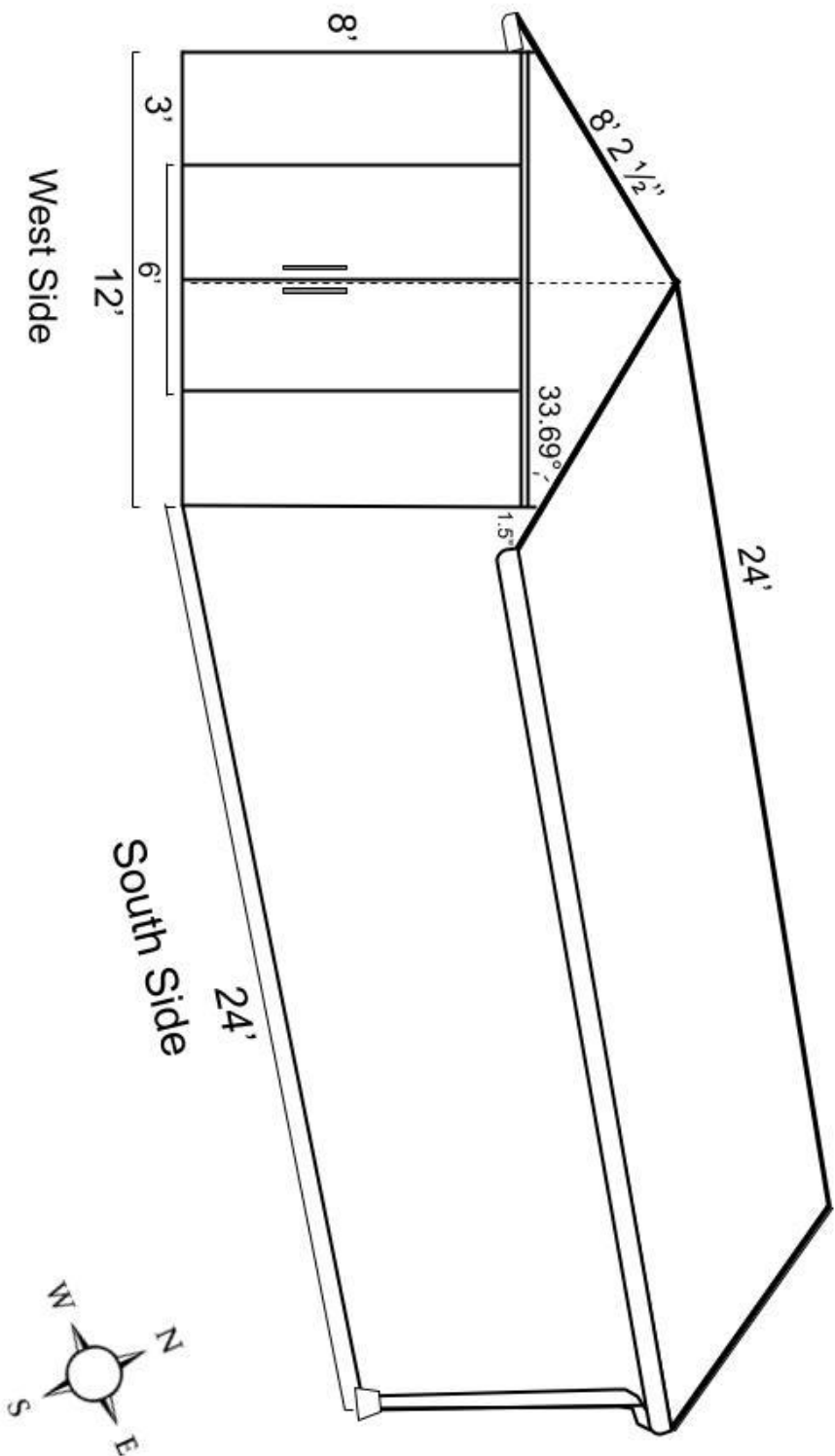

#1-2: Dimensions & North Arrow
Northeastern view

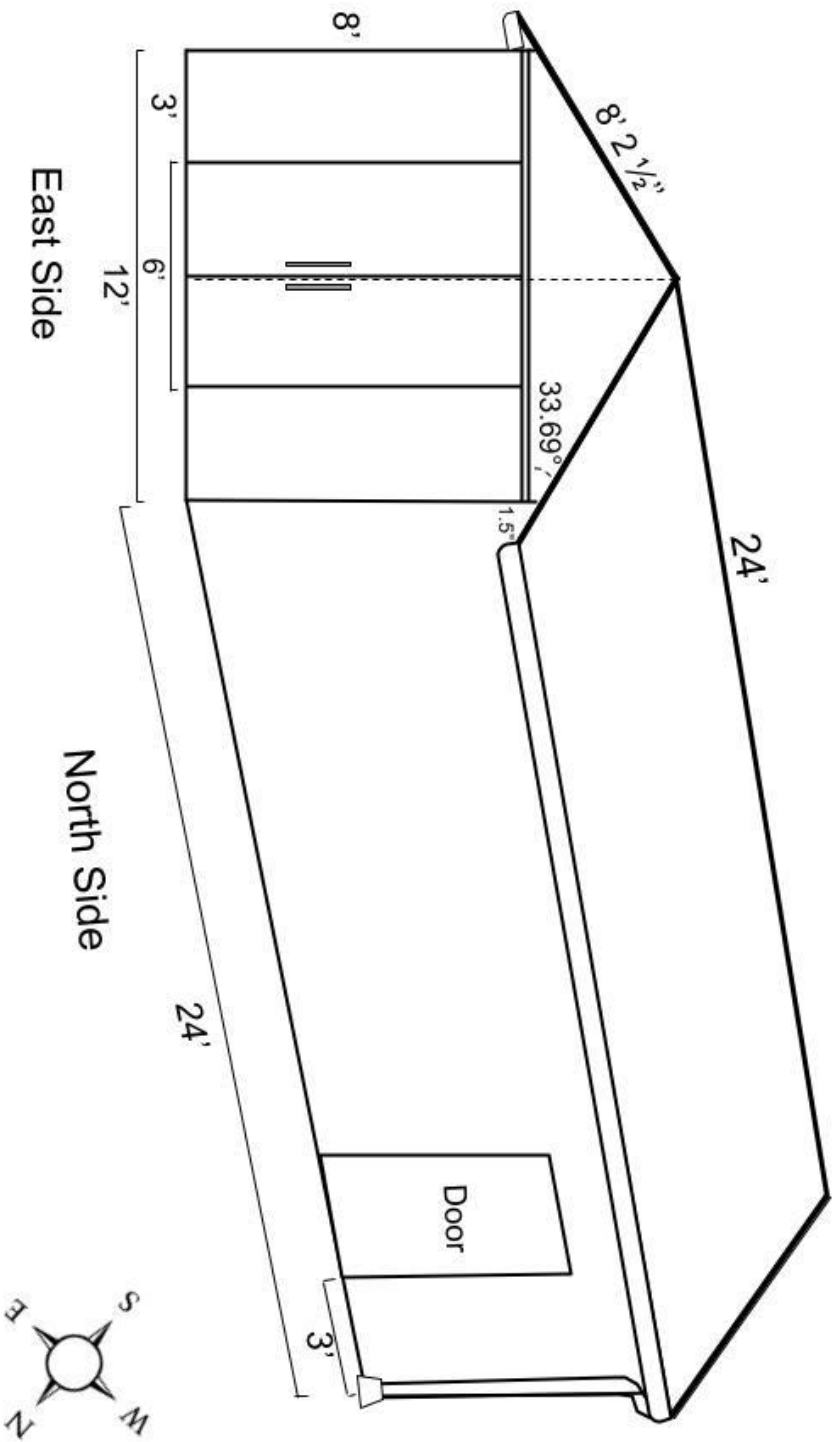

#2-1: Site Boundary

The blue outline defines the area known as the La Center Garden.

The La Center Garden is located on the southwest corner of the La Center High School Campus.

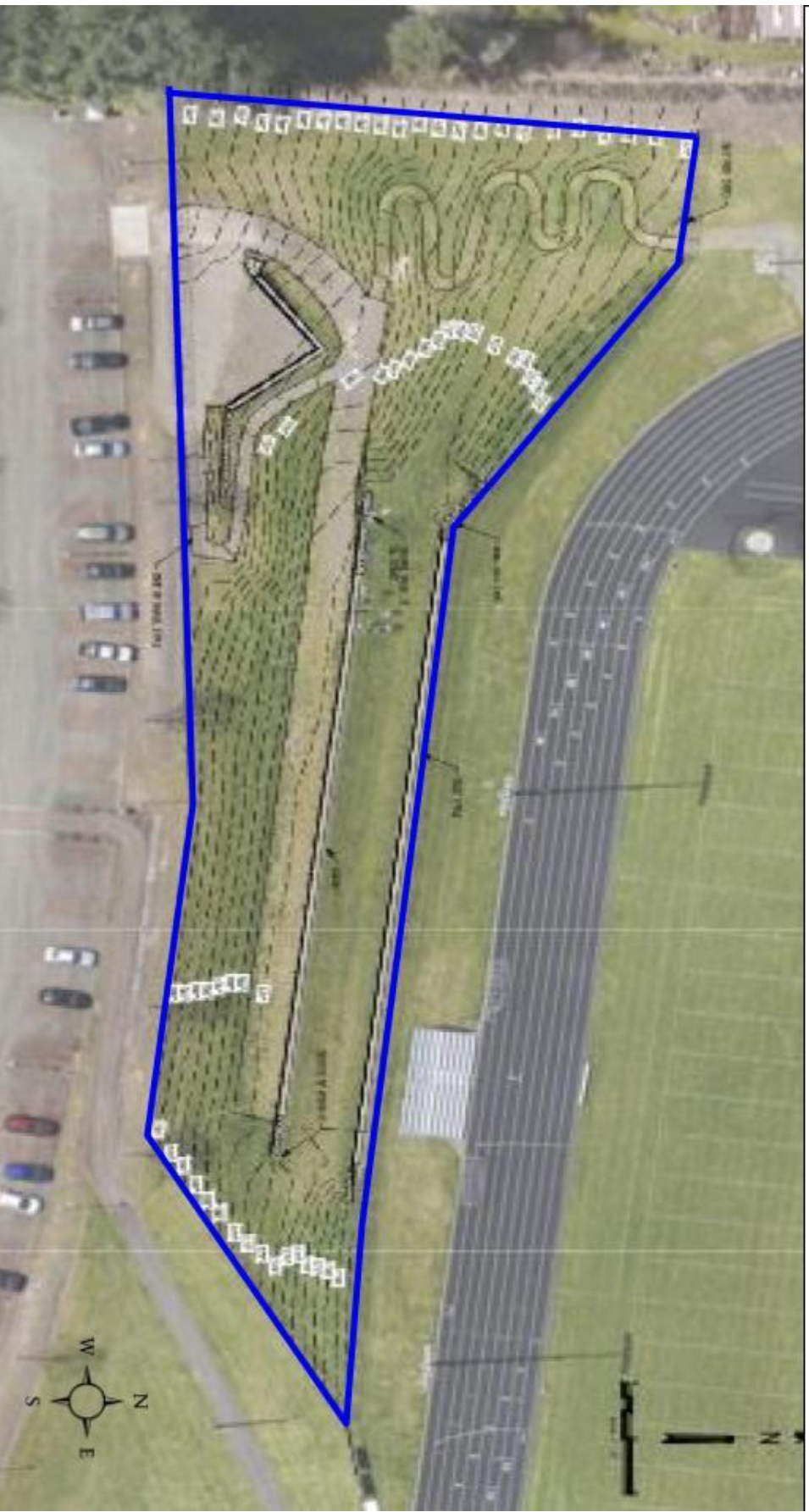

#3-1: Proposed Name of Project: La Center GreenShed



#4-1: Vicinity Map - LCHS Campus & Surrounding area

-  La Center High School Campus
-  La Center Garden
-  GreenShed (proposed)



#4-2: Vicinity Map - LCHS Campus

- La Center High School Campus
- La Center Garden
- Greenshed (proposed)



#4-3: Vicinity Map -LC Garden w/ Greenshed

- Blue outline defines the area known as the La Center Garden.
- Green rectangle denoted the location of the proposed LC Greenshed
- *The La Center Garden is located on the southwest corner of the La Center High School Campus.
- Light blue trapezoid shows the location of the Rain Garden

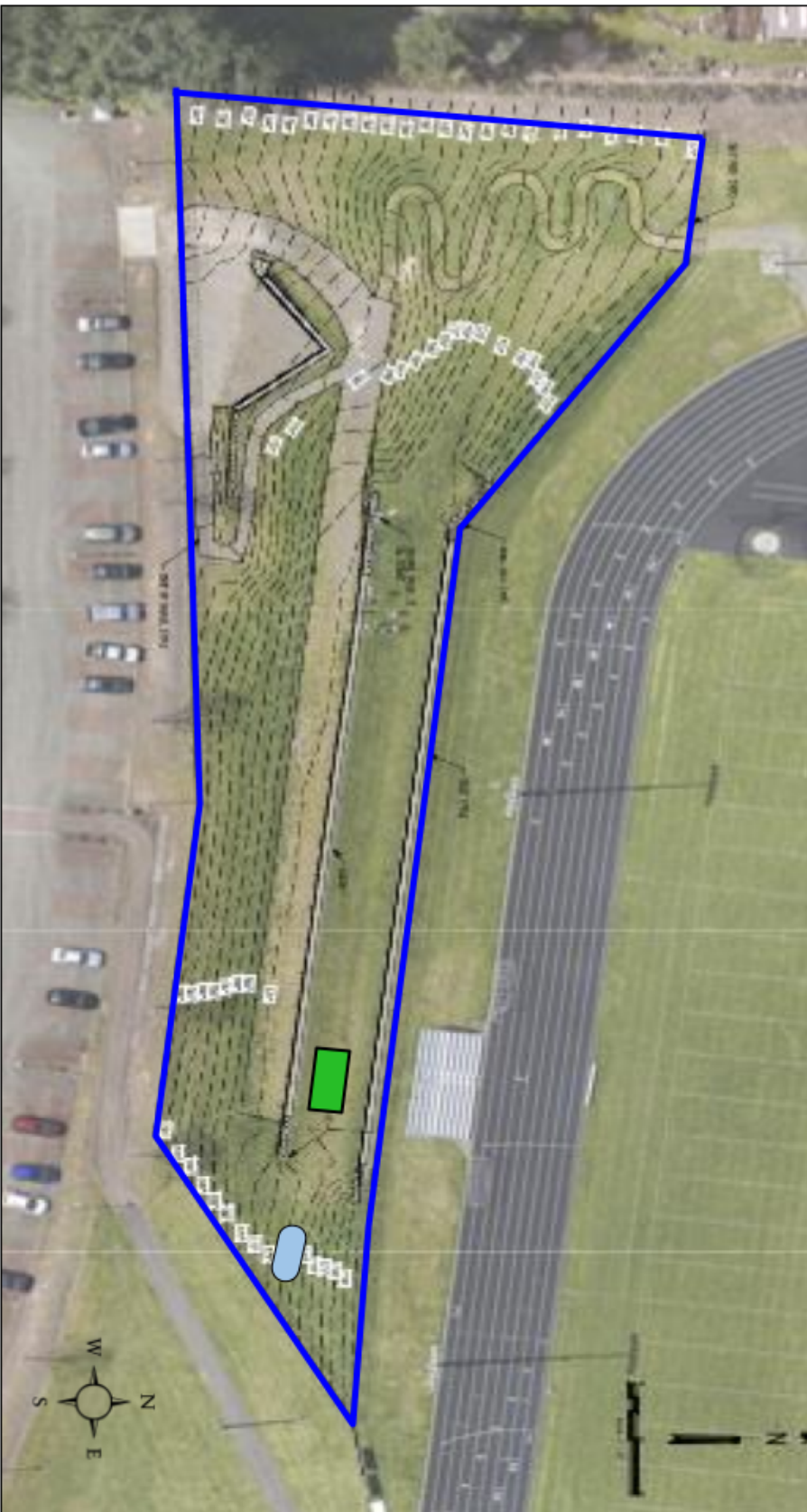

#5-1: Configuration - overview

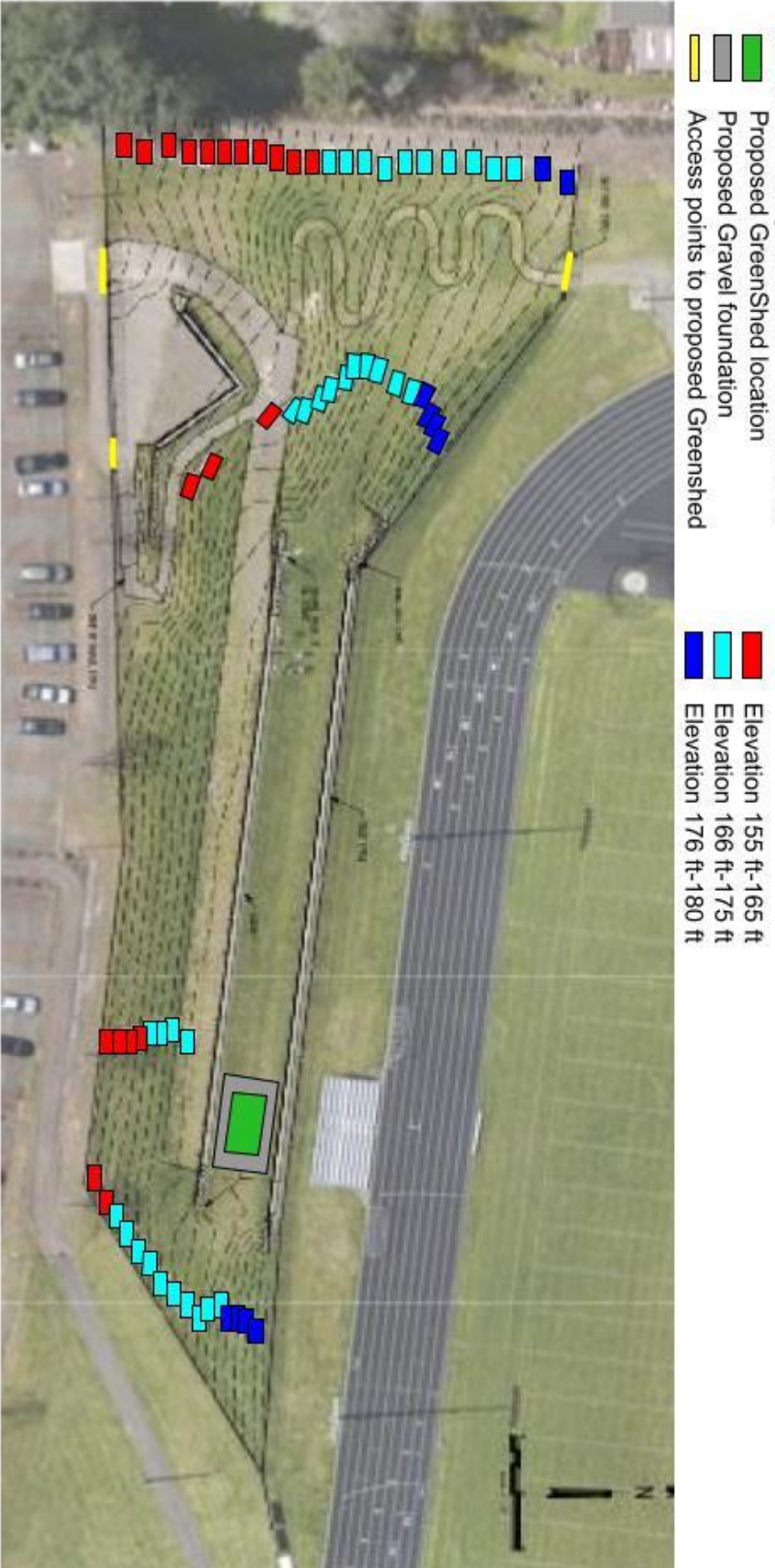

#5-2: Drainage system

The proposed 12 foot x 24 foot La Center GreenShed is to be constructed upon a semi-permeable gravel foundation, allowing for filtration of rainwater. Additionally, the shed is to be built on a sloped hill. Our intention is to collect rainwater in rain barrels with overflow routed to a rain garden. The sloped hillside coupled with the mitigation of an amended rain garden will permit rainwater to flow into the stormwater drainage system located within the infrastructure of the lower parking lot and 4th St. roadway to the south of the La Center Garden.

During the process of developing the La Center Garden in 2016, the contractor installed large retaining walls. These retaining walls were specifically designed to provide stability to each level of the LC Garden, as well as to mitigate erosion and stormwater run-off within the LC Garden. The lower parking lot, located to the south of the La Center Garden and proposed building site for the GreenShed, is paved with permeable pavers that allow for runoff to filter into the ground around and beneath them. Additionally, the parking lot, sloped toward 4th St., is equipped with a drainage system that routes the water into the City of La Center's stormwater system that flows into the creek south of Holley Park.

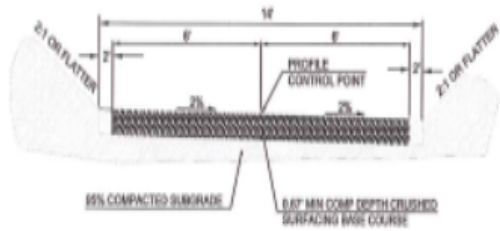

Station 0+10 to Station 4+25
GRAVEL ACCESS ROAD
TYPICAL SECTION
 MTS

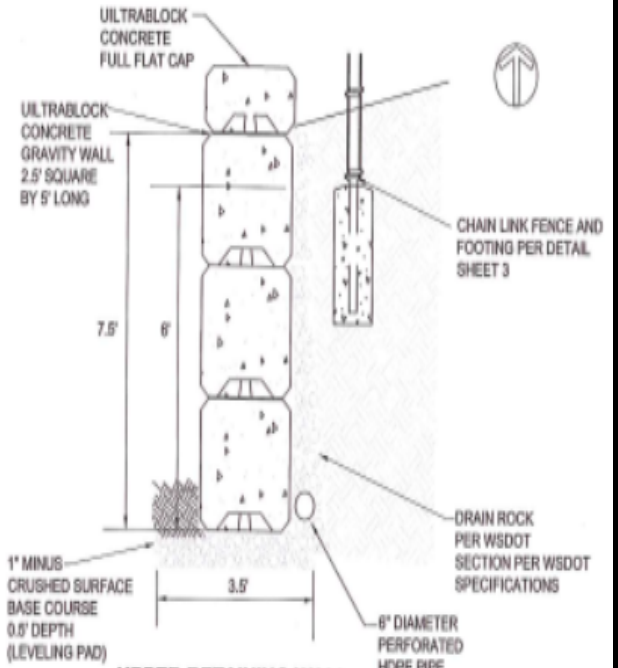

UPPER RETAINING WALL
SECTION
ALTERNATE BID
 MTS

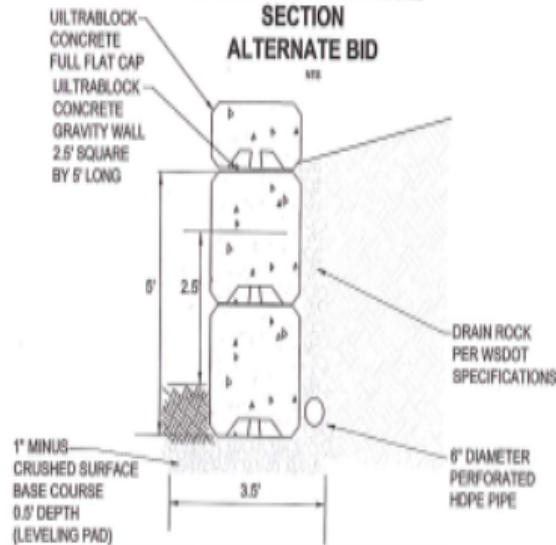

MATERIAL STOCKPILE RETAINING WALL
SECTION
ALTERNATE BID
 MTS

DETAIL SHEET 1

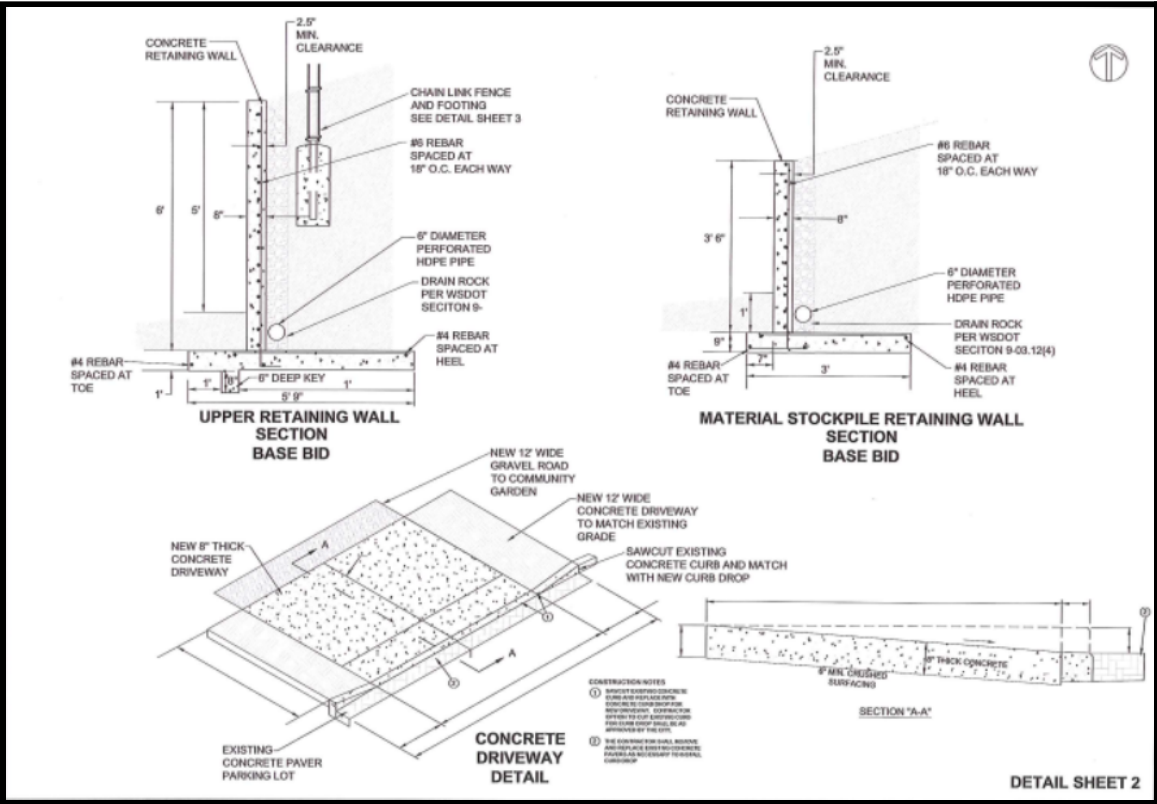

Configuration & Dimensions

- The green rectangle is the 12'x24' GreenShed
- The gray rectangle is the 18"x29' area where gravel/crushed asphalt will be placed.





#5-3: Configuration - topo (Zoom-able)

#5-4: Dimensions - overview

- Pedestrian pathway to the east side entrance from lower parking lot to the GreenShed
- Distance between southeast corner and up to retaining wall (69ft)
- Distance between southeast corner and northeast corner (120ft)



#6-1: Existing and Proposed Buildings & Structures



Dark blue lines depict the eco-block retaining walls on the north & south of the GreenShed

Lighter blue lines depict the eco-block retaining walls near the southern entrance

Purple outlines the visitor bleachers in the La Center SD track and field area

Green rectangle denotes the location of the GreenShed (proposed)

Light blue trapezoid shows the location of the Rain Garden

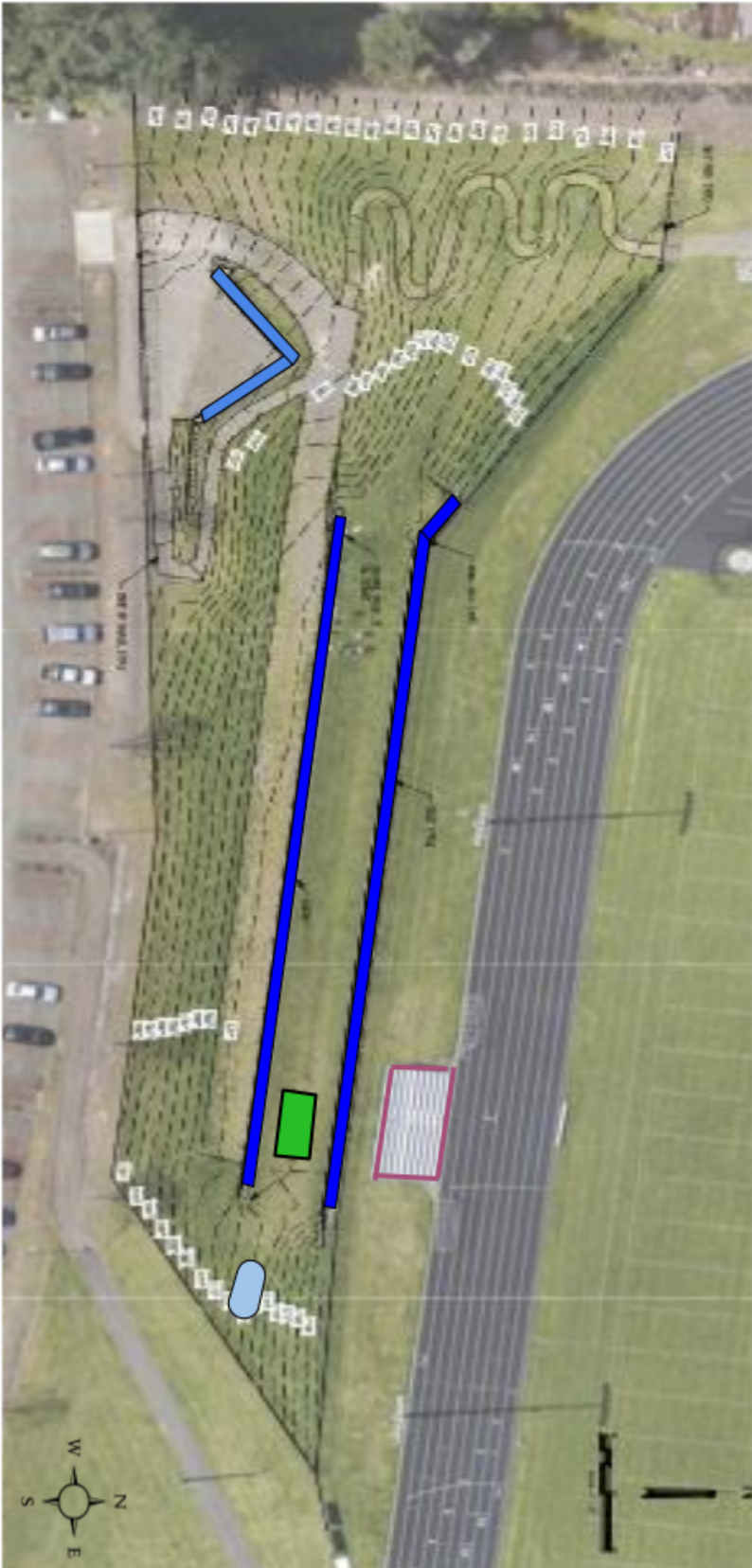

#7-1: Proposed Uses for Buildings & Structures - GreenShed

The La Center Garden's Greenshed will serve both utilitarian and educational purposes. As a garden shed, it will provide storage for tools and materials related to the maintenance of and improvements to the La Center Garden. Its pole barn design will allow interior shelving as well as space for storing a small garden tractor, gardening tools, pots, and other materials for constructing components within the garden.

The GreenShed is also a learning opportunity for students at La Center High School. The planning, designing, presenting, and constructing of the structure is being done by students in both the Environmental Studies and Residential Construction Classes. Coordinating the efforts of these classes and other project partnerships is part of the purpose of the Environmental Action Team, an LCHS ASB Club.

The long-term vision for the La Center GreenShed within the La Center Garden is that it will continue to serve as a storage shed, but will also serve as a legacy project for students within La Center Schools, the wider La Center community, and visitors to our town to learn about environmental sustainability. As an outdoor learning space, the La Center Garden and the La Center GreenShed, in particular, will have exhibits and educational signage explaining: sustainable land use, waste reduction, watershed stewardship and clean/renewable energy sources. The latter of these sustainable demonstrations will include the GreenShed's being equipped with solar panels to provide lighting in and around the GreenShed. Permits for this later phase of the project will be processed by one of our GreenShed partners, Clark PUD and their contracted solar contractor- Sunbridge Solar. There will be no charge for visitors, and students will serve as hosts and tour guides to the La Center GreenShed site.

Our Greenshed will be a positive addition to our town, the education of students, and the community of La Center. Its usefulness is already underway through the pre-construction and planning phase.

#8-1: Sided & Unsided Views from North

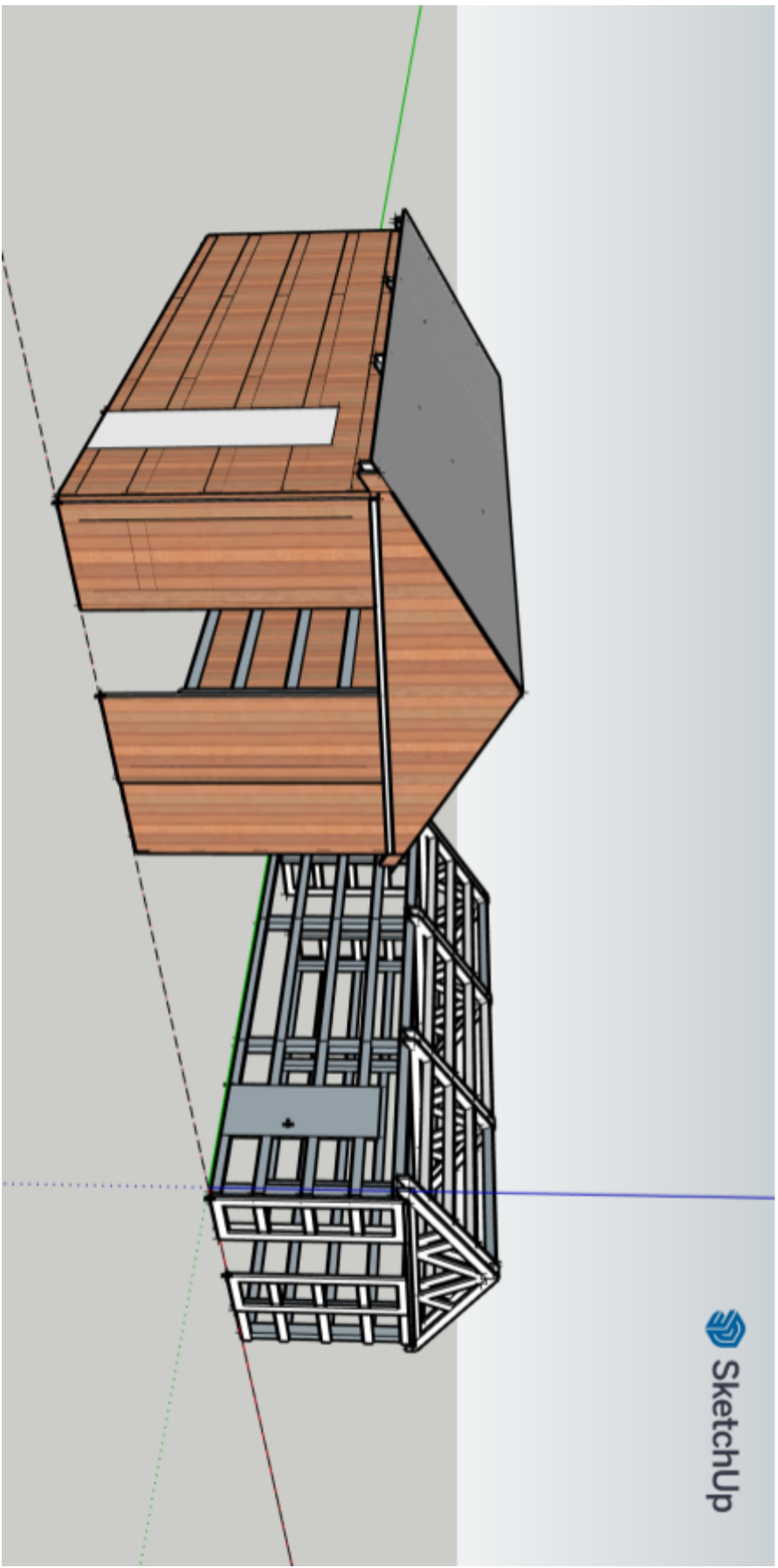

#8-2: Skeleton Finished NE View

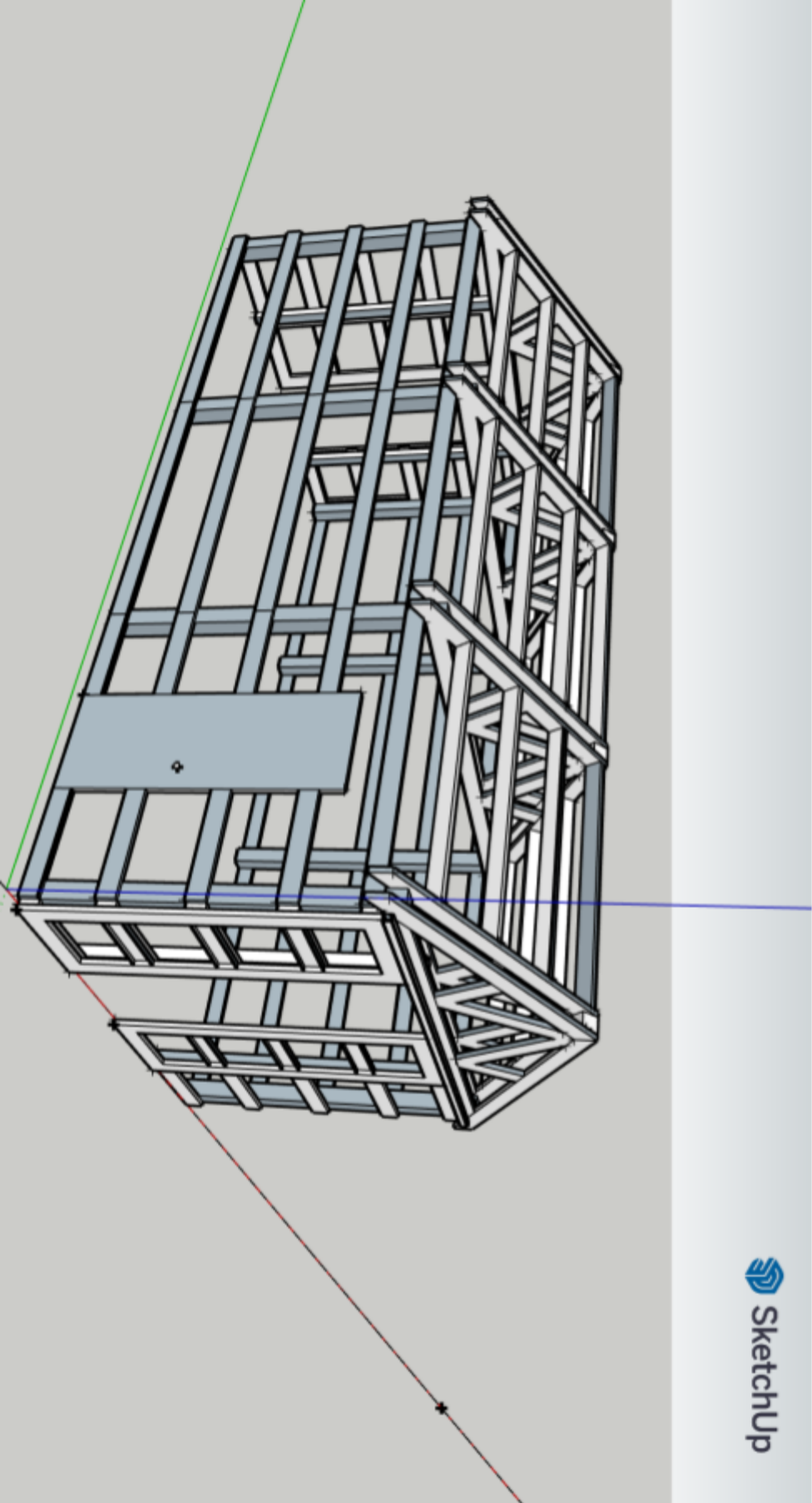

#8-2.1: Gutter on Shed

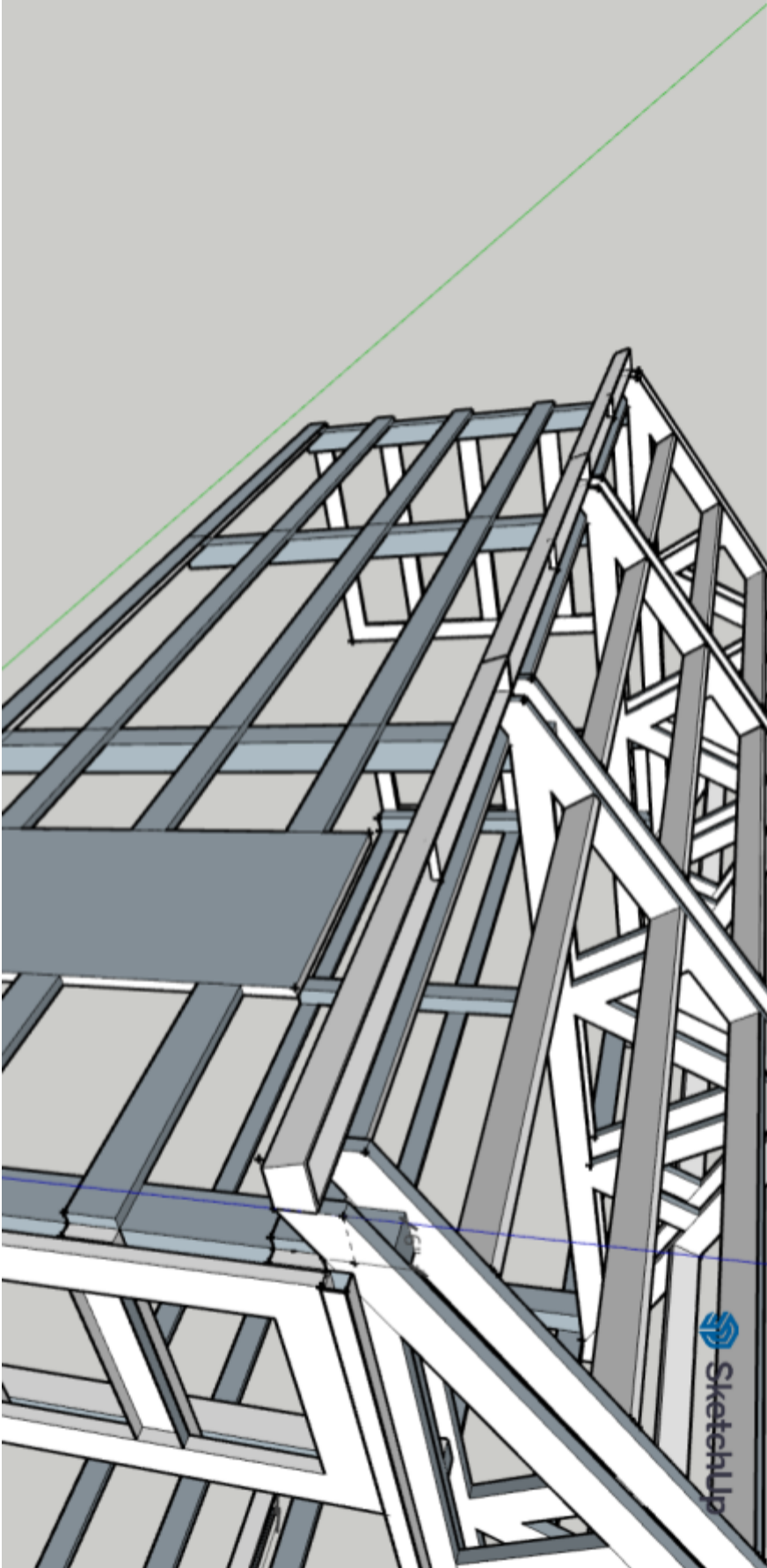

#8-2.2: Gutter

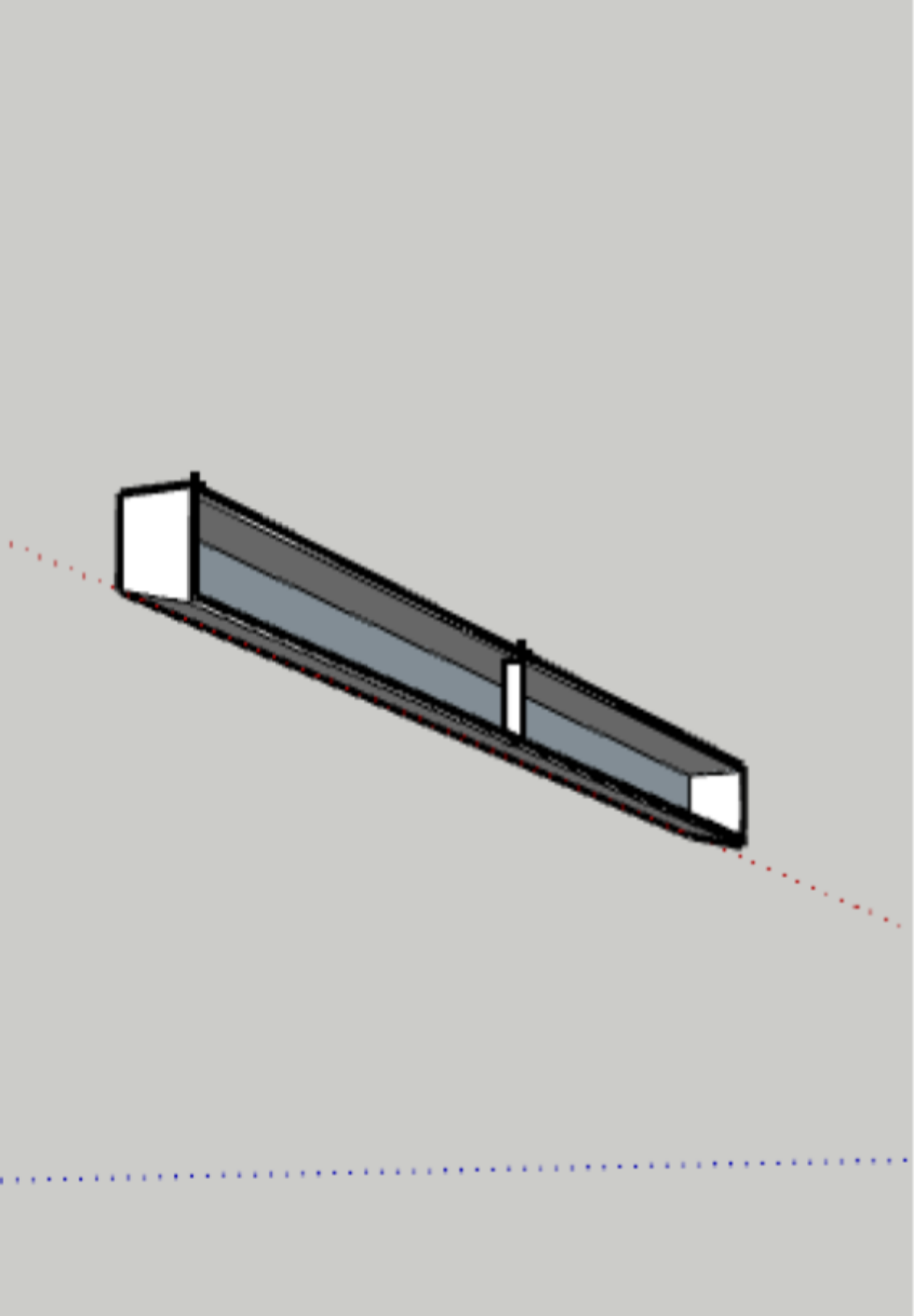

#8-3: Skeleton Finished-West View

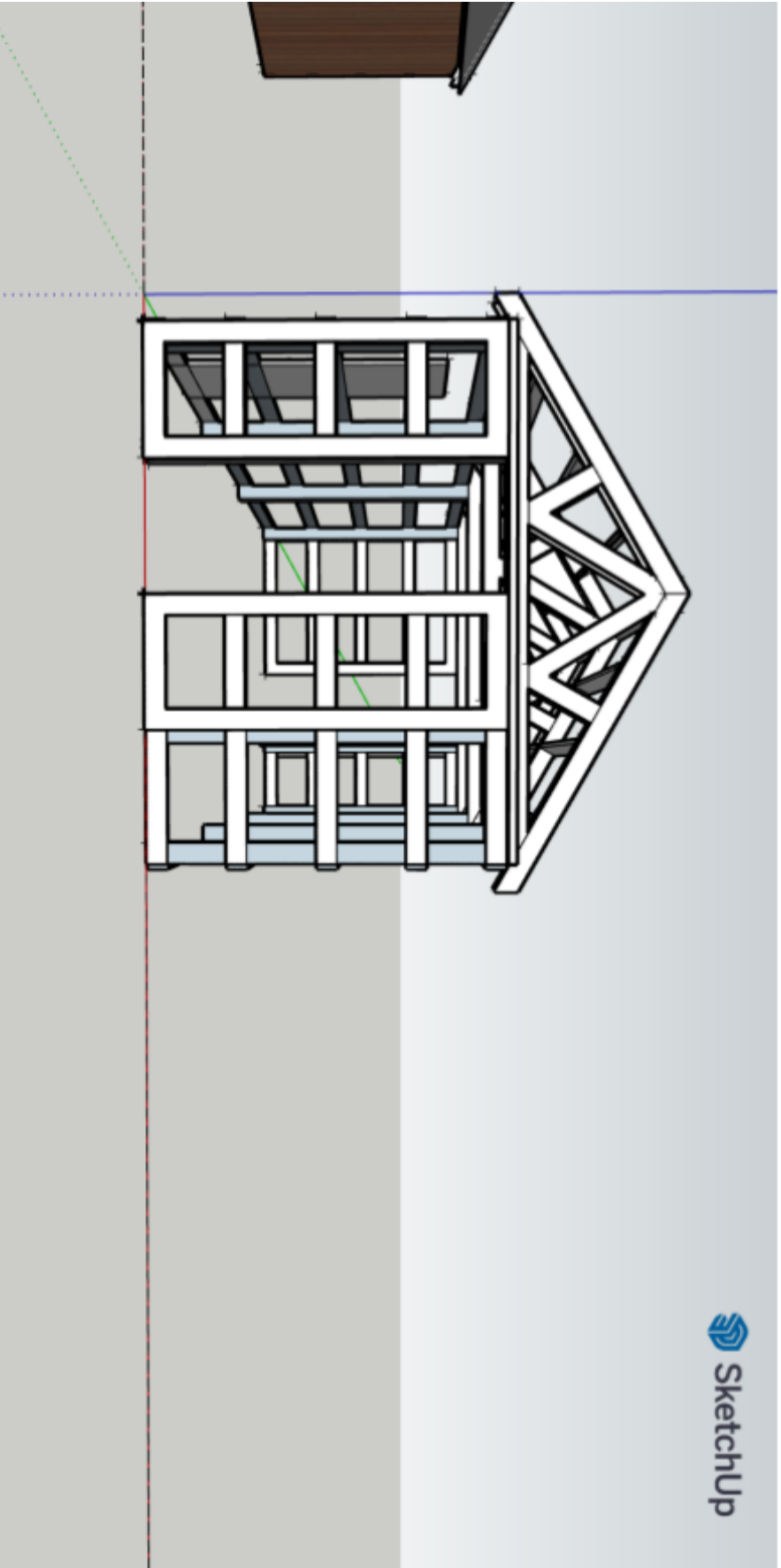

#8-4: Door Railing (West & East)

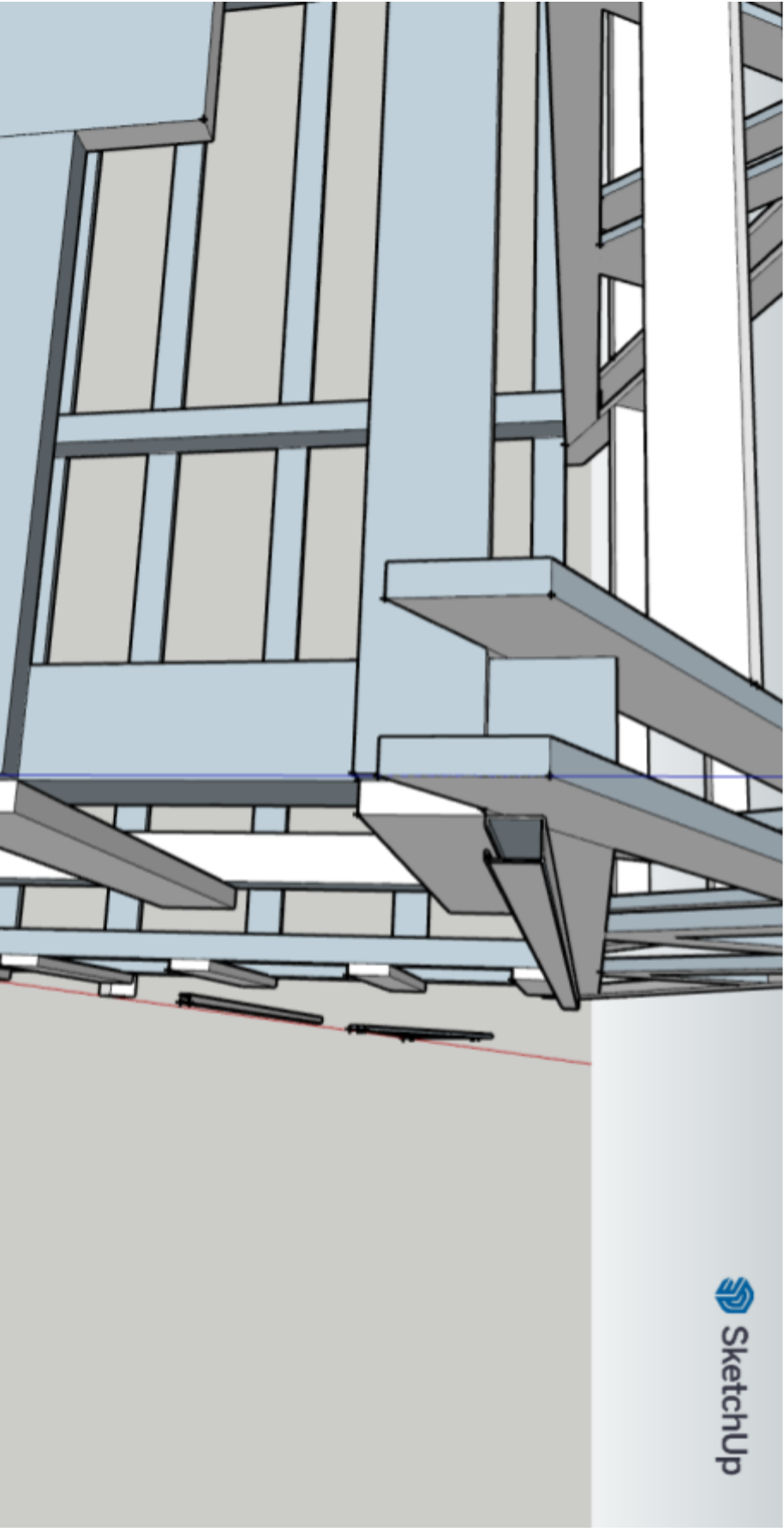

#8-5: Internal Header Installation and Rails

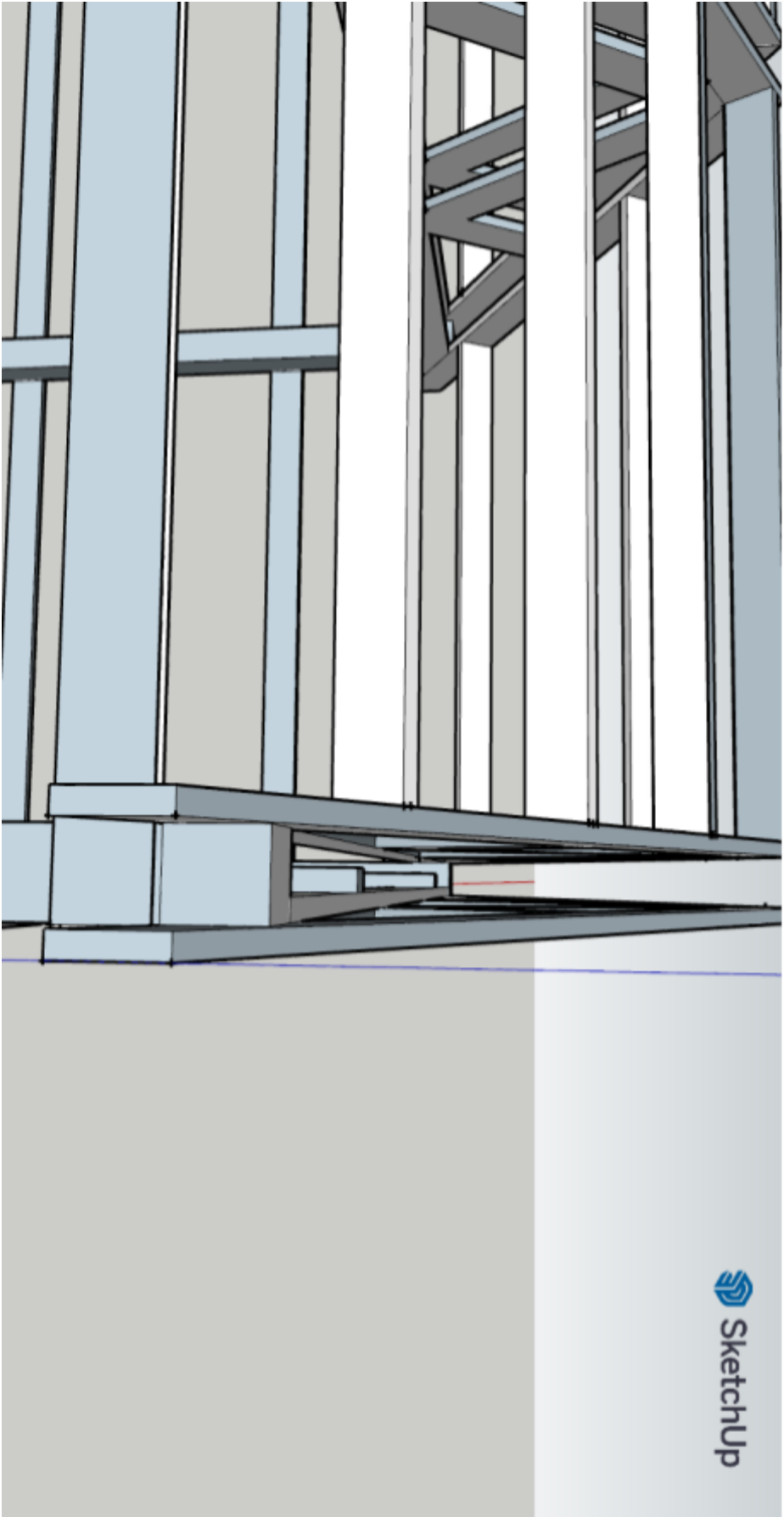

#8-6.1: Service Door Placement

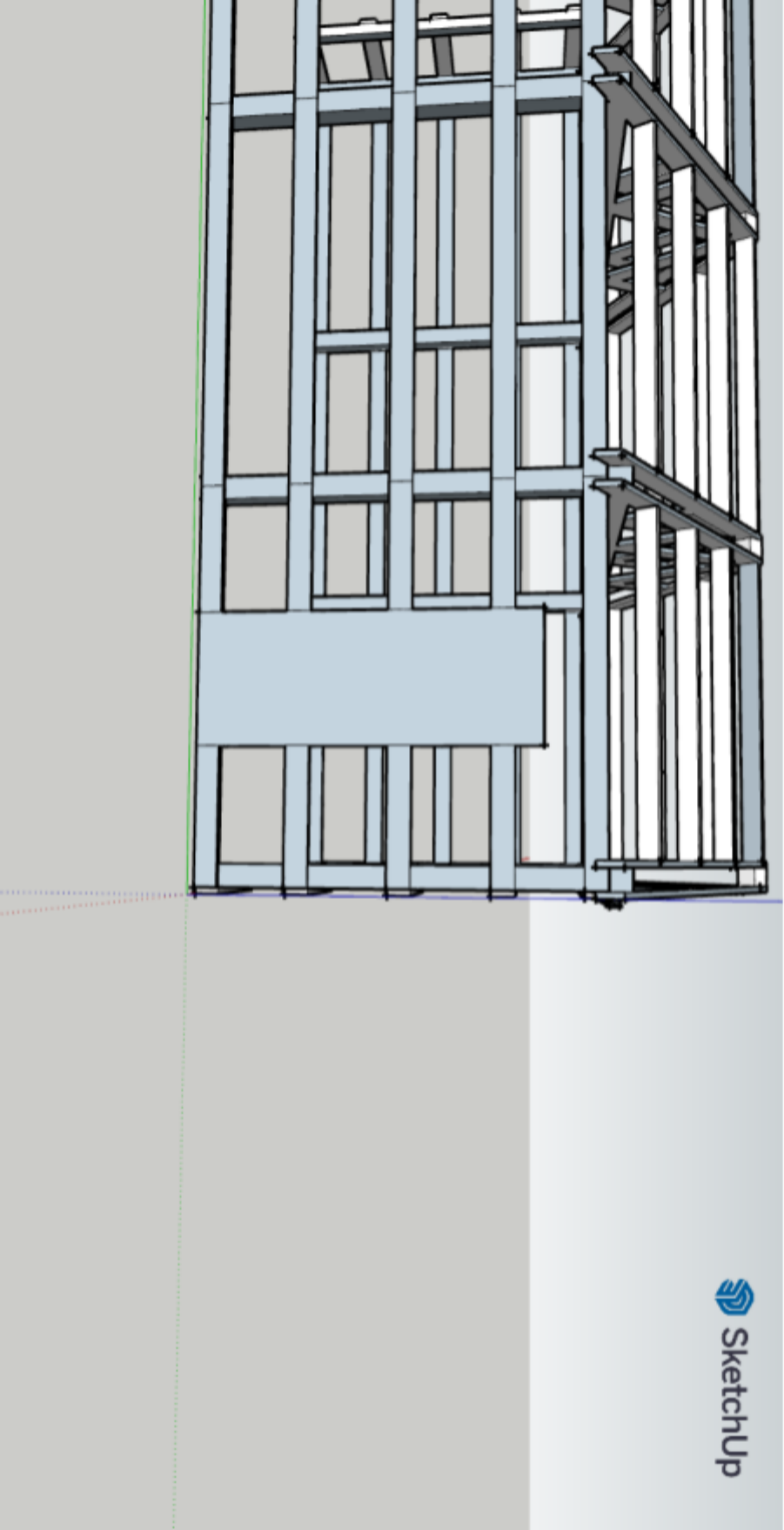

#8-6.2: Rain Barrel Addition

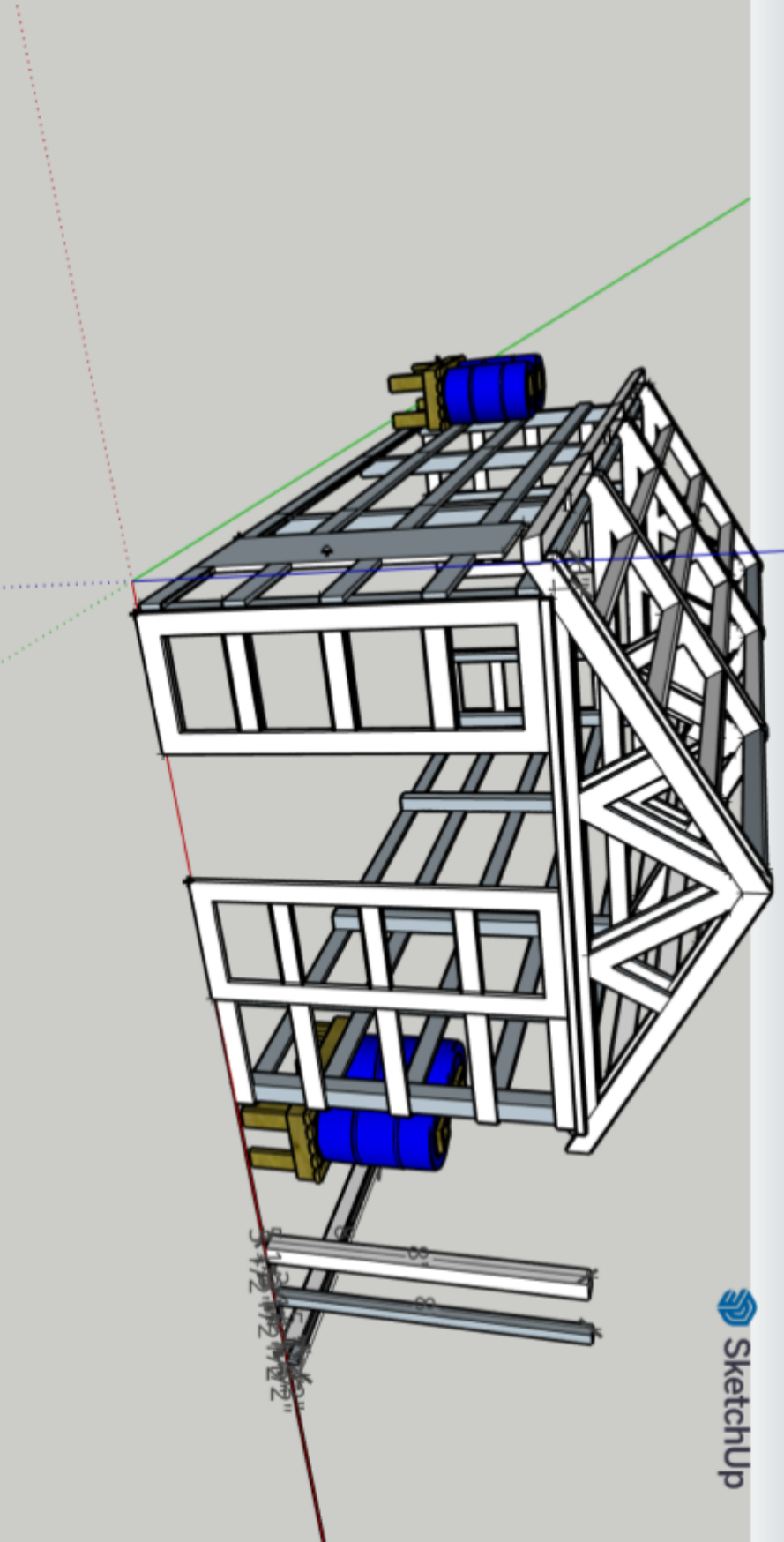

#8-7: Finishing of Perlongs

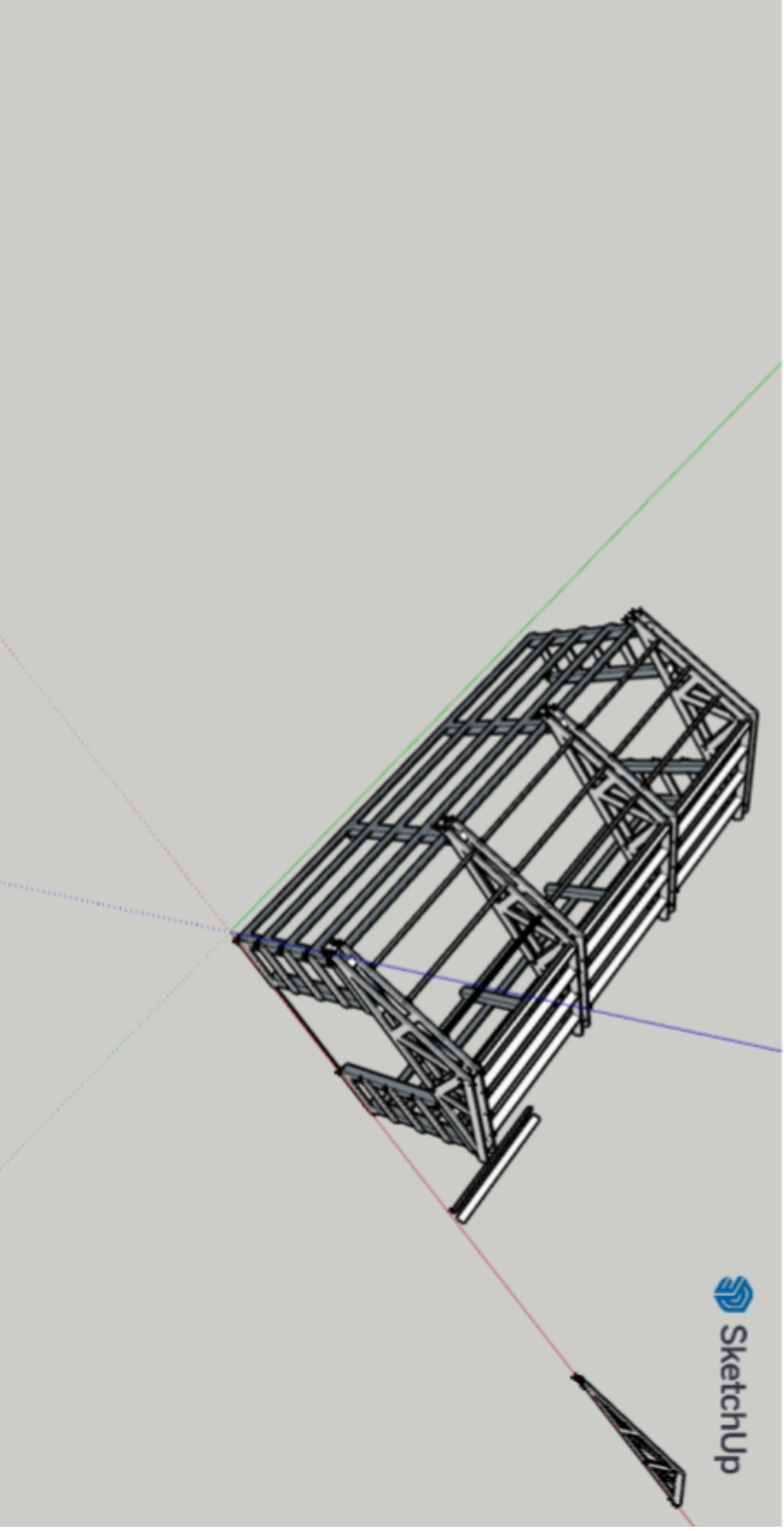

#8-8: Continuation of Perlongs Build

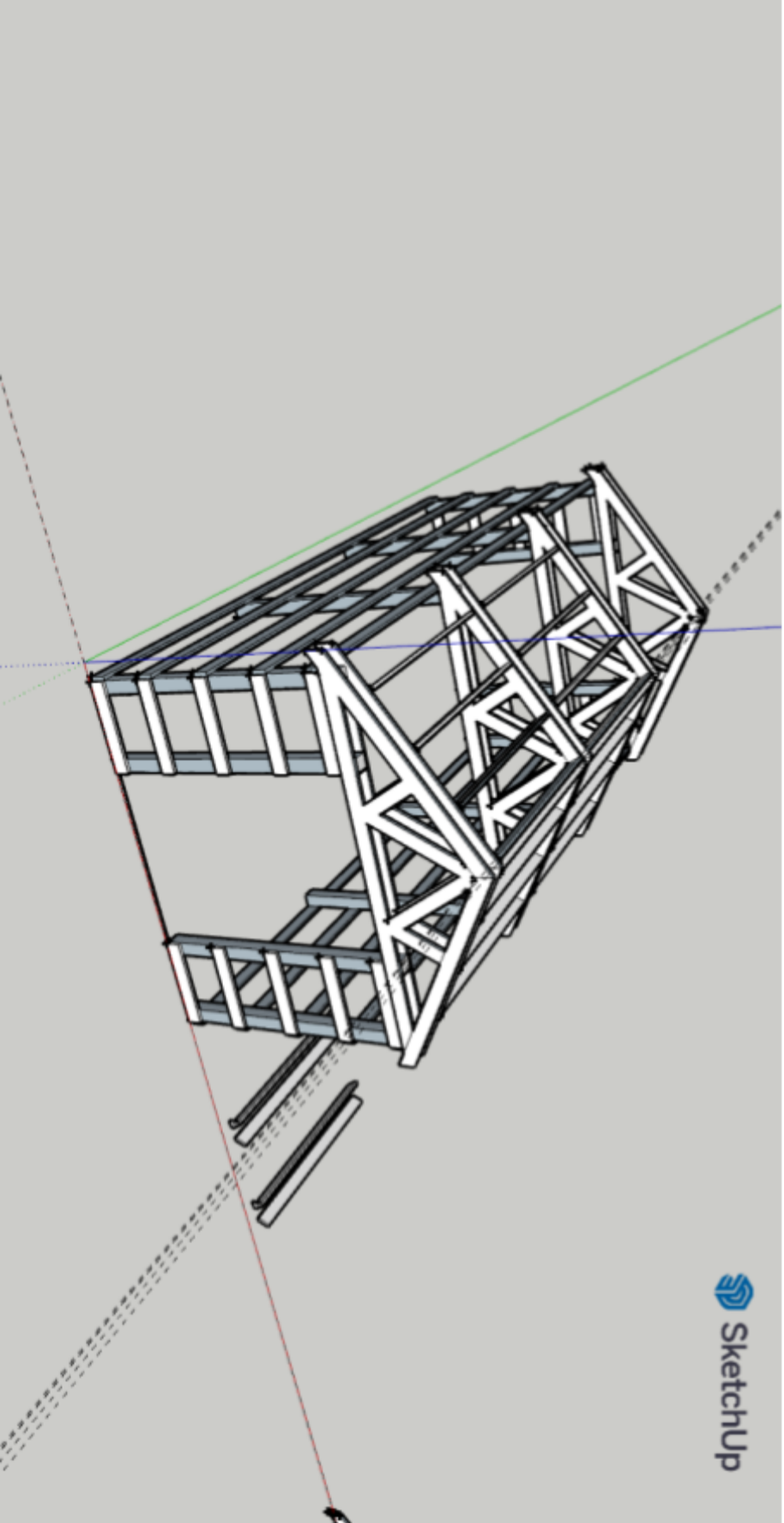

#8-9: Overhang Rebuild #1

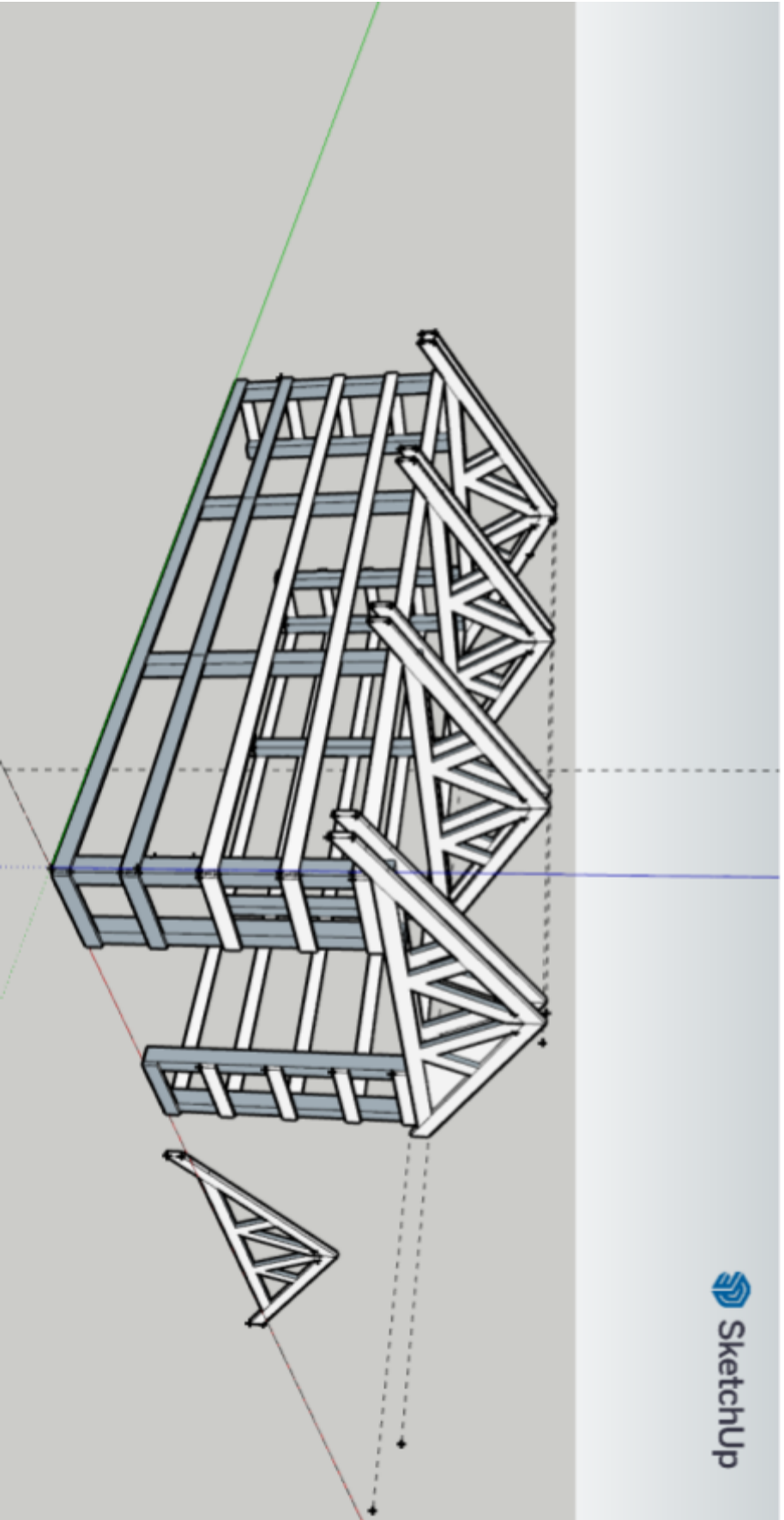

#8-11: Truss Build #1

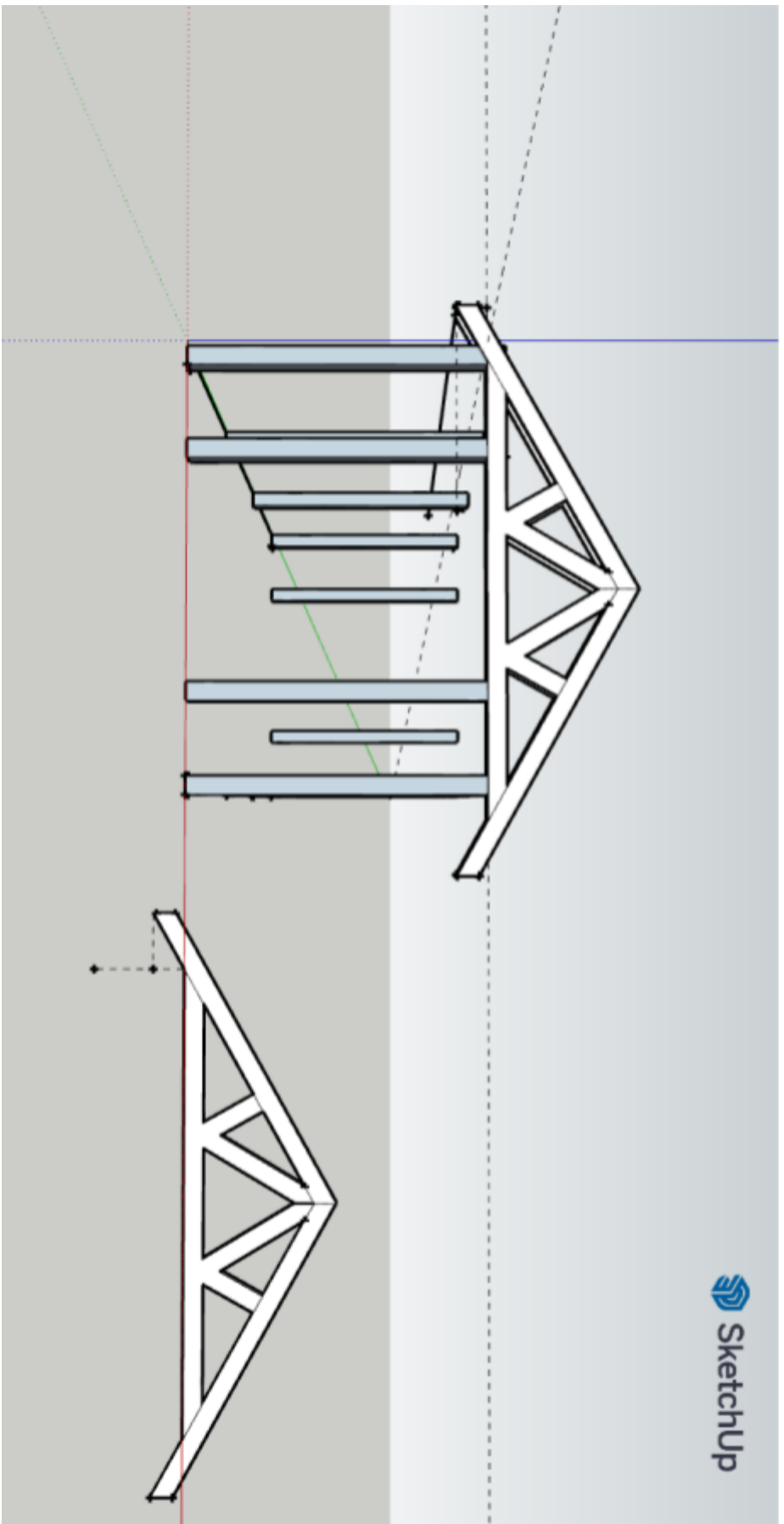

#8-12: Truss Rebuild #1

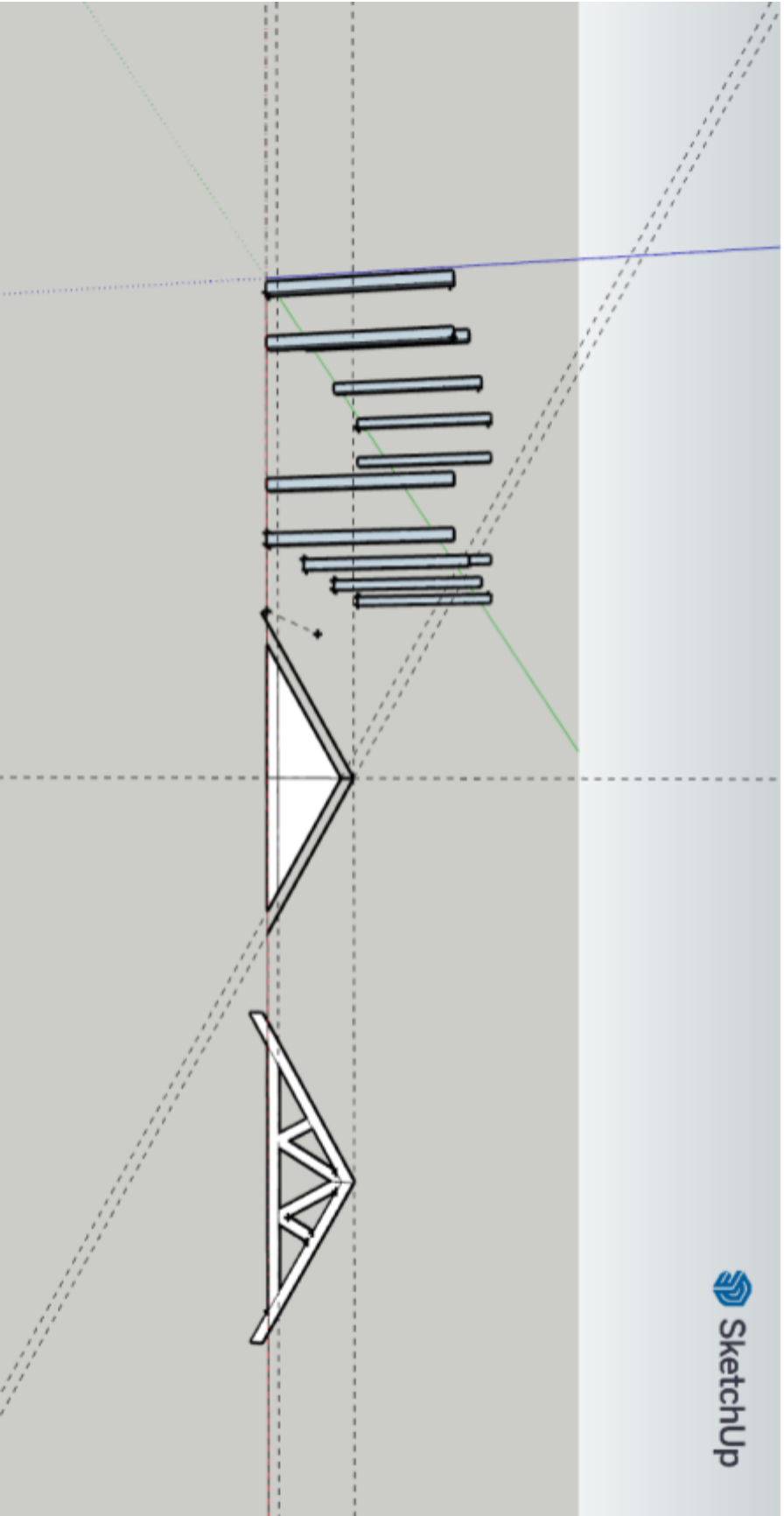

#8-L1: Ariel w/ posts noted

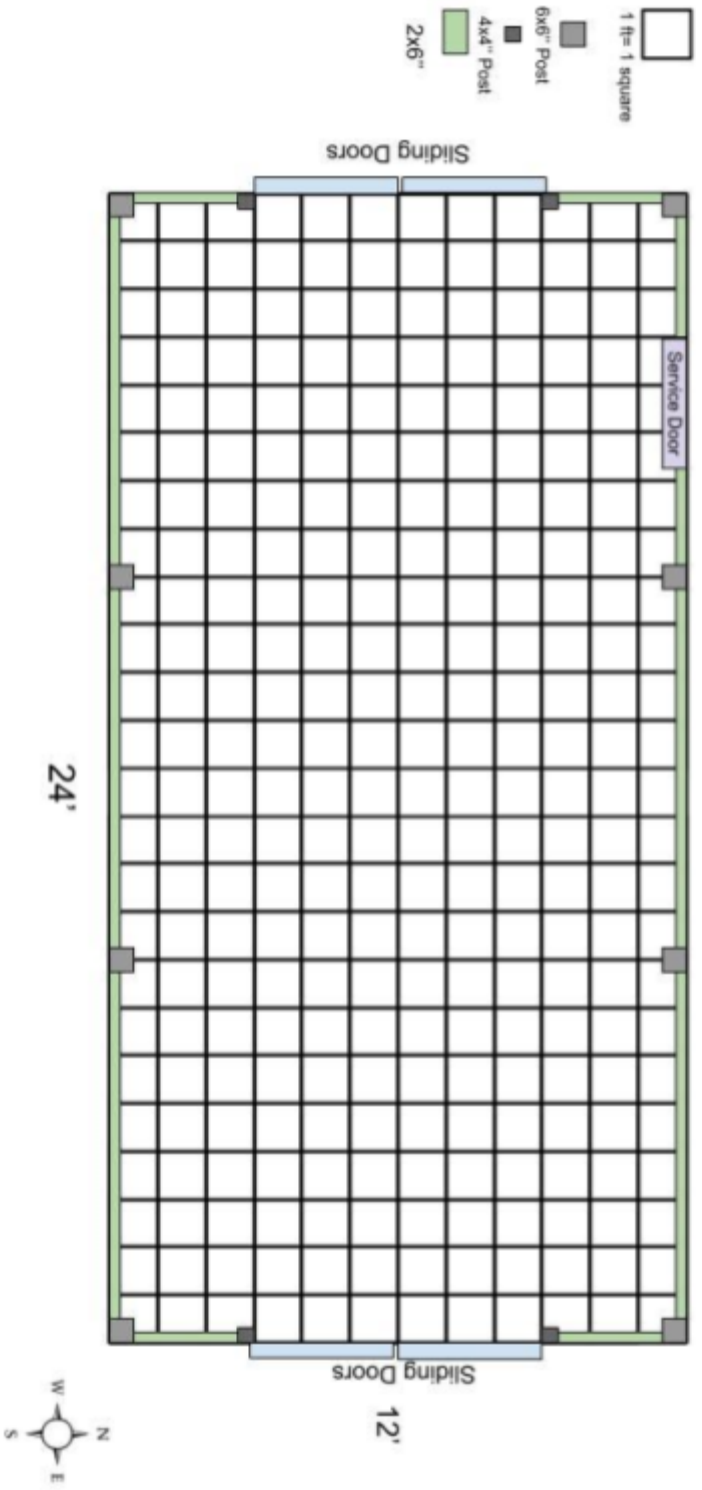

#8-L2: Northern View w/ Lumber

North Side

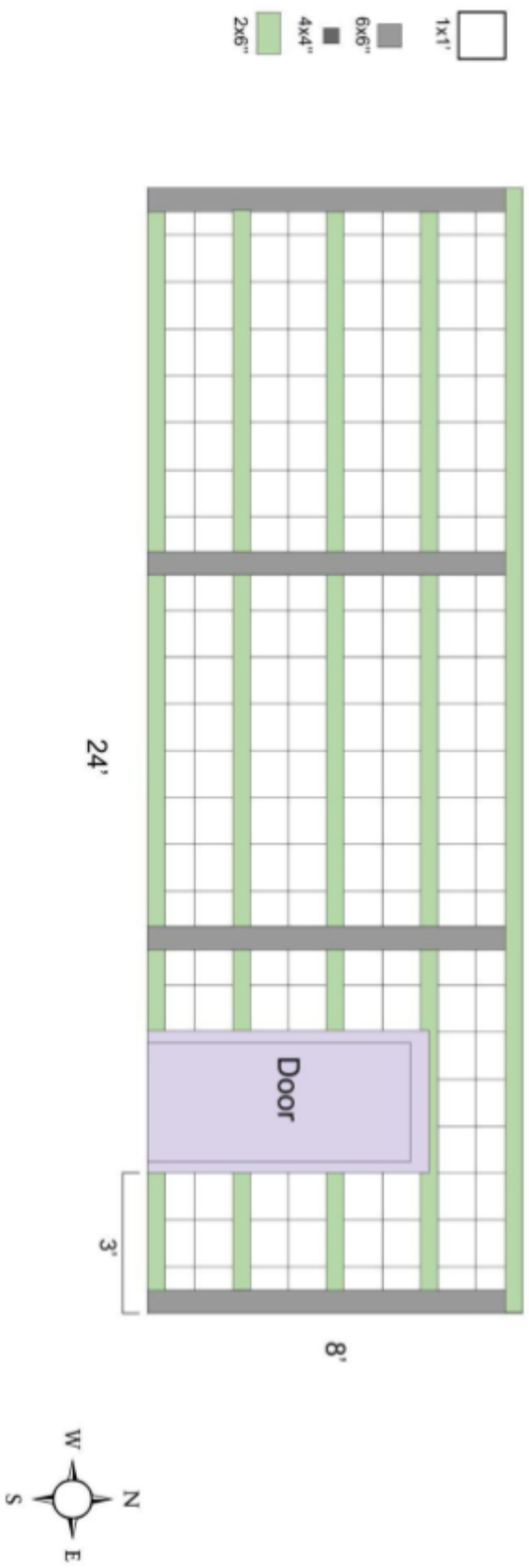

#8-L3: Western View w/ Lumber

Western view

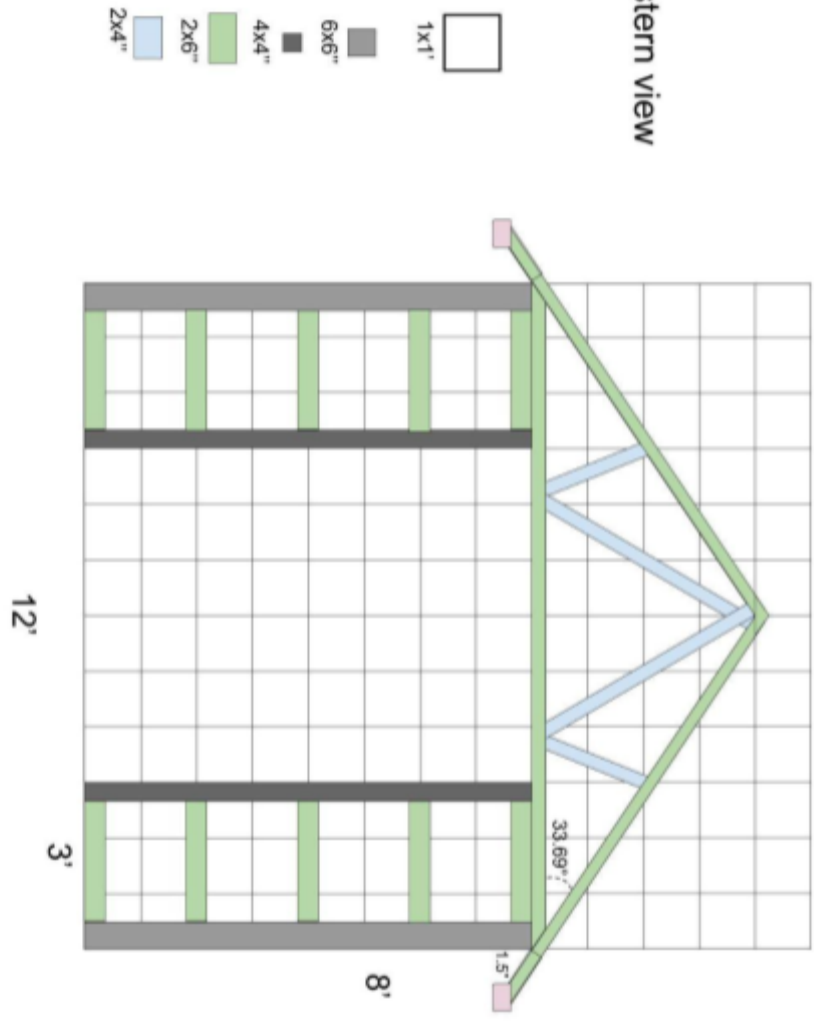

#8-L4: Southern View w/ Lumber

South Side

- 1x1'
- 6x6"
- 4x4"
- 2x6"

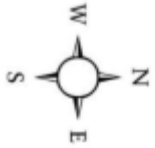
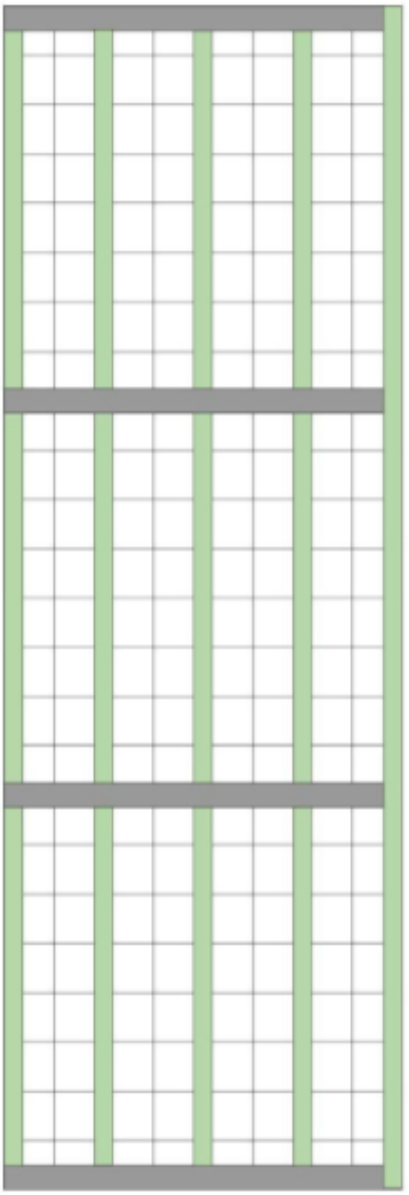

#8-L5: Eastern View w/ Lumber

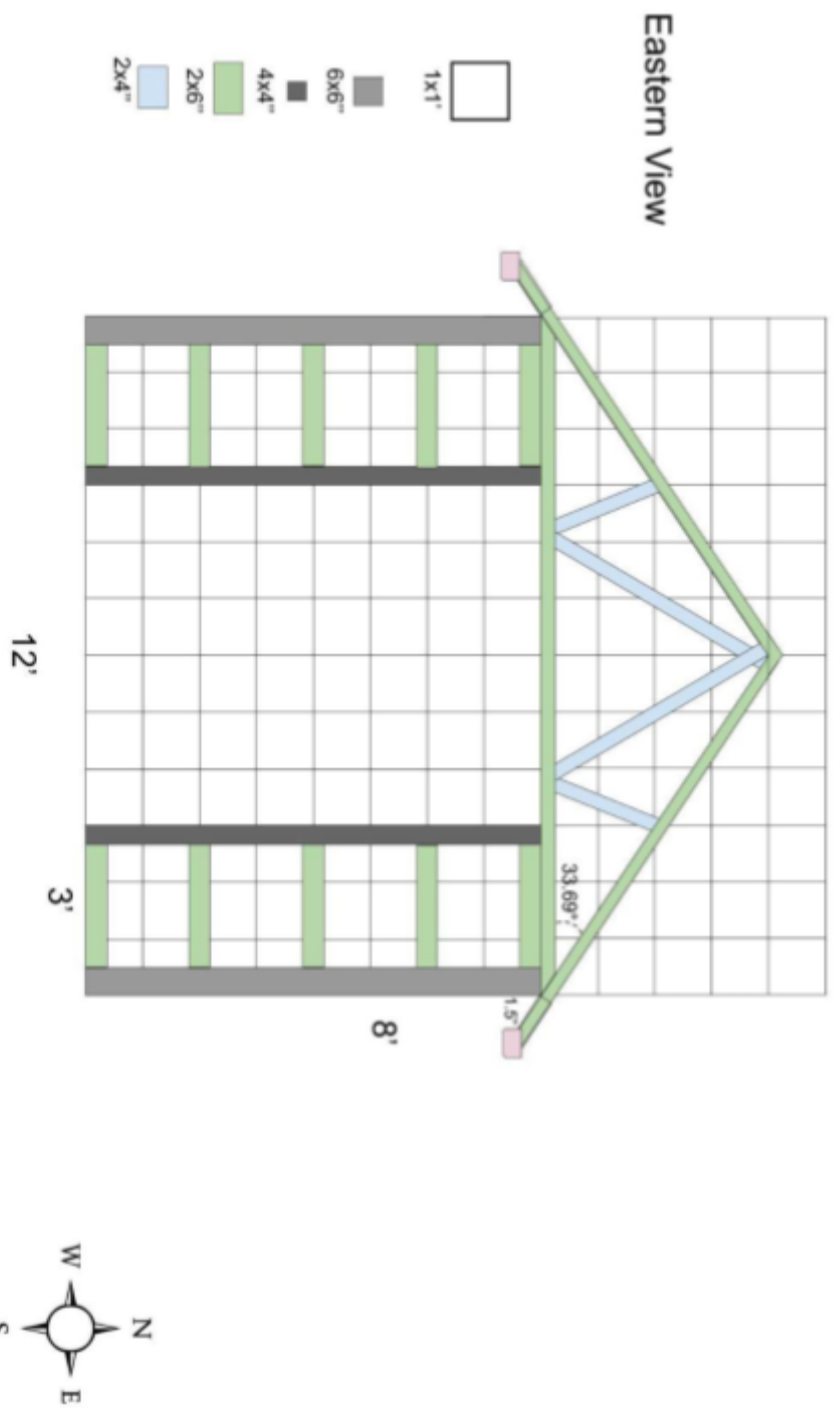

#9-1: Walls & Fences - Locations

- Blue lines depict the retaining walls within the La Center Garden (existing)
- Red lines depict the cyclone fencing (existing)
- Purple line depicts the location of the large Laurel hedge (existing)
- Green denotes the location of the GreenShed (proposed)

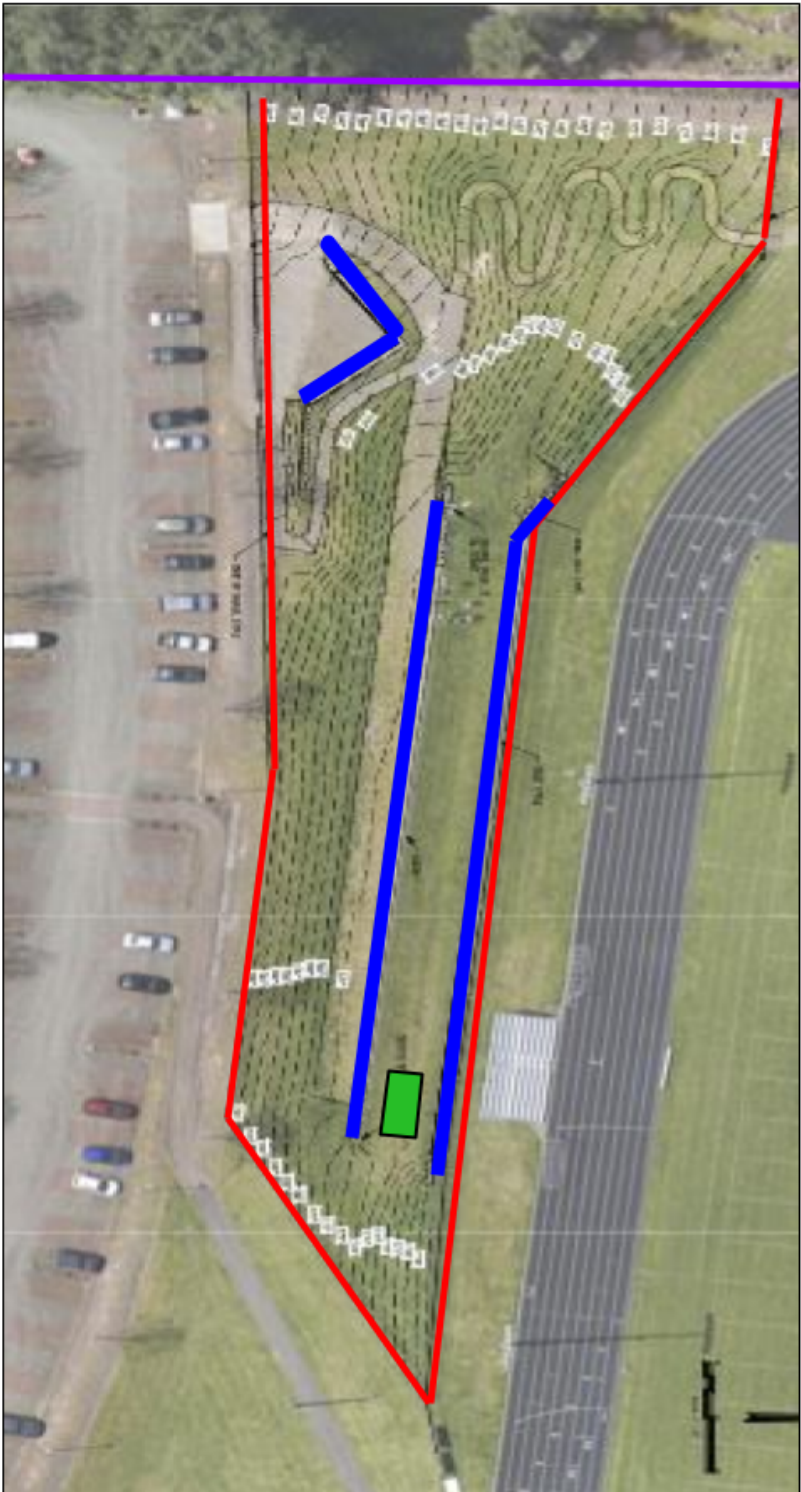

#9-2: Walls & Fences - Heights and Construction Material

- Retaining walls: Cement Eco-blocks and large boulders
 - Fencing: Metal cyclone
 - All cyclone fencing is 6 ft. high
 - Walls vary from 3ft 10in to 5ft. 9in.
- *All walls and fencing are pre-existing; no additional walls or fences are proposed to be added.
 **The green rectangle denotes the location of the GreenShed (proposed)

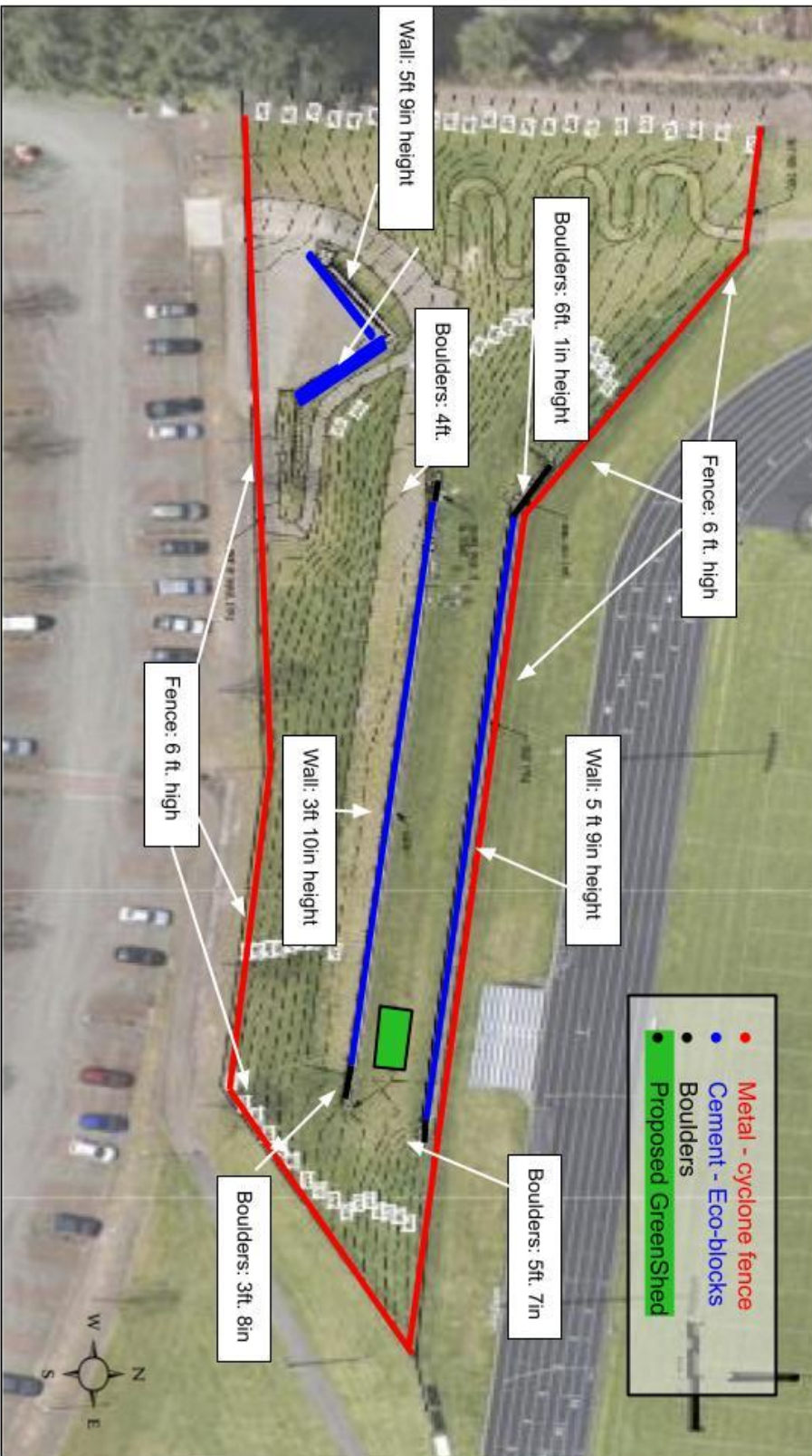

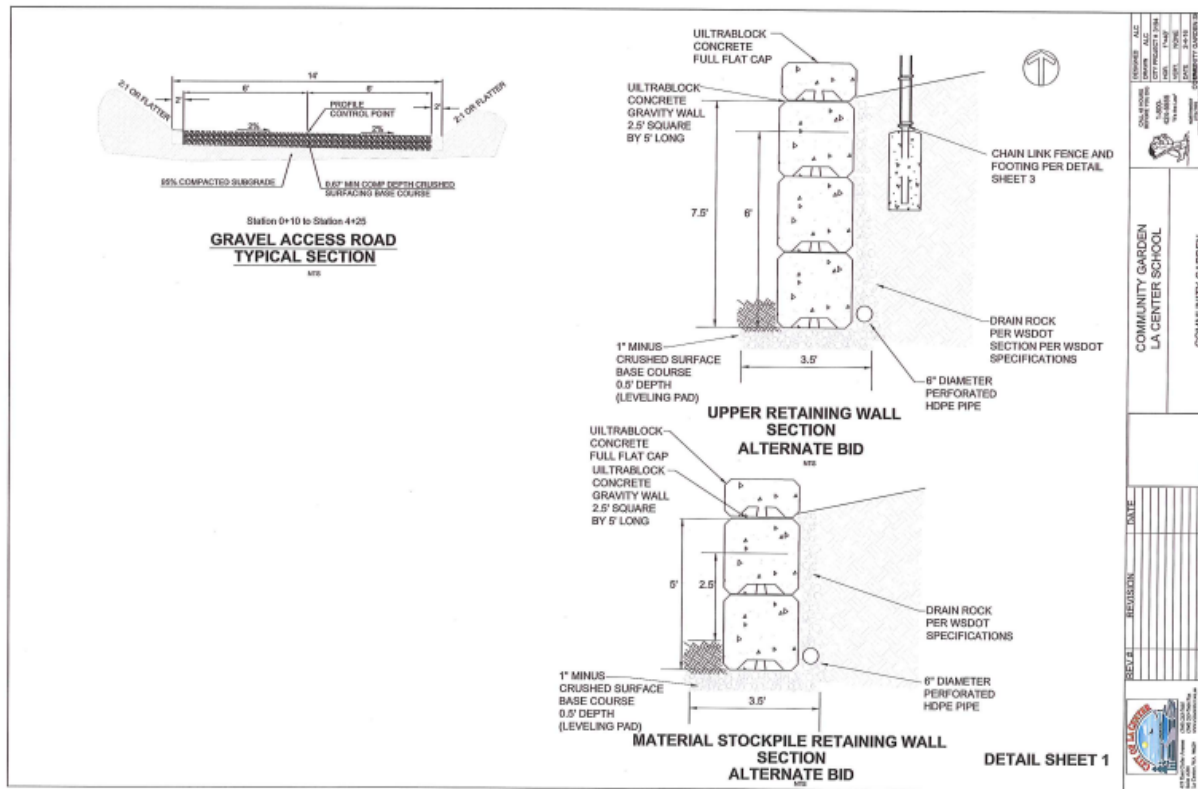
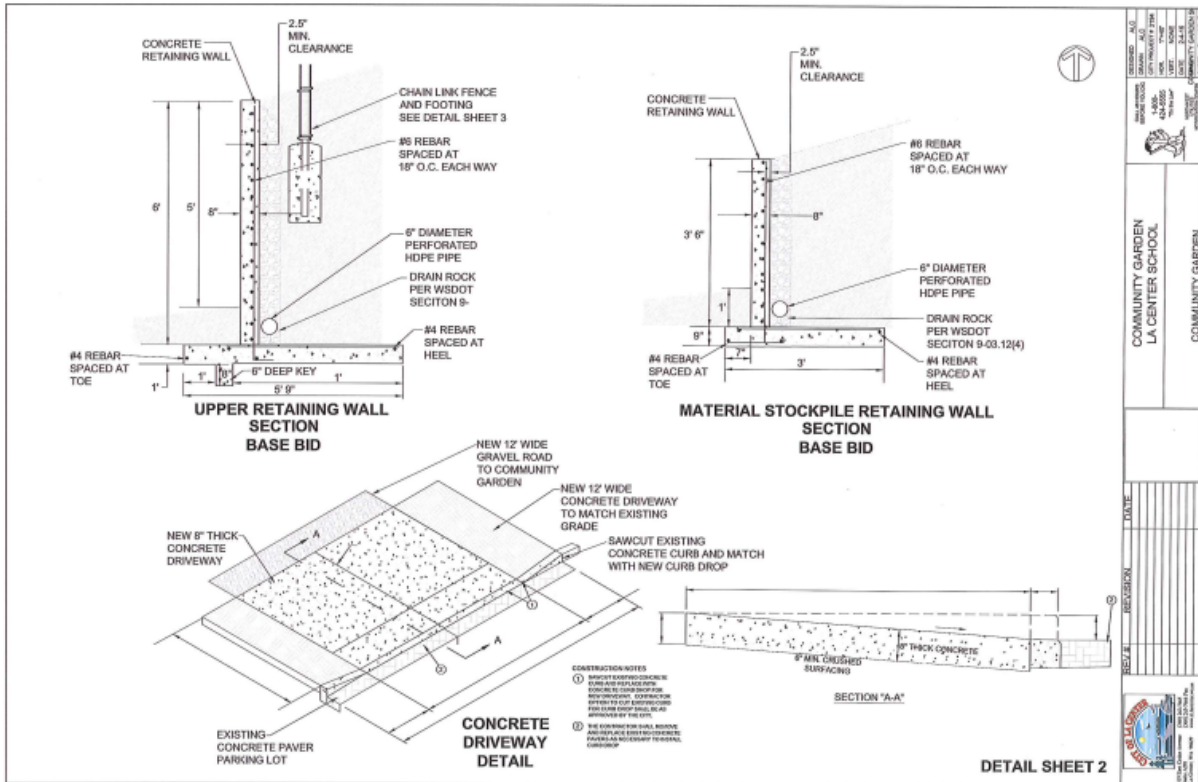

#9-3: 2016 Eco Block Wall Diagrams



2016 La Center Garden Plans created by Anthony Cooper, City of La Center

#10-1: General Location & Configuration of ... Landscaping > LCHS Campus & Surrounding area

-  La Center High School Campus
-  La Center Garden
-  GreenShed (proposed)



#10-2: LCHS Campus & LC Garden



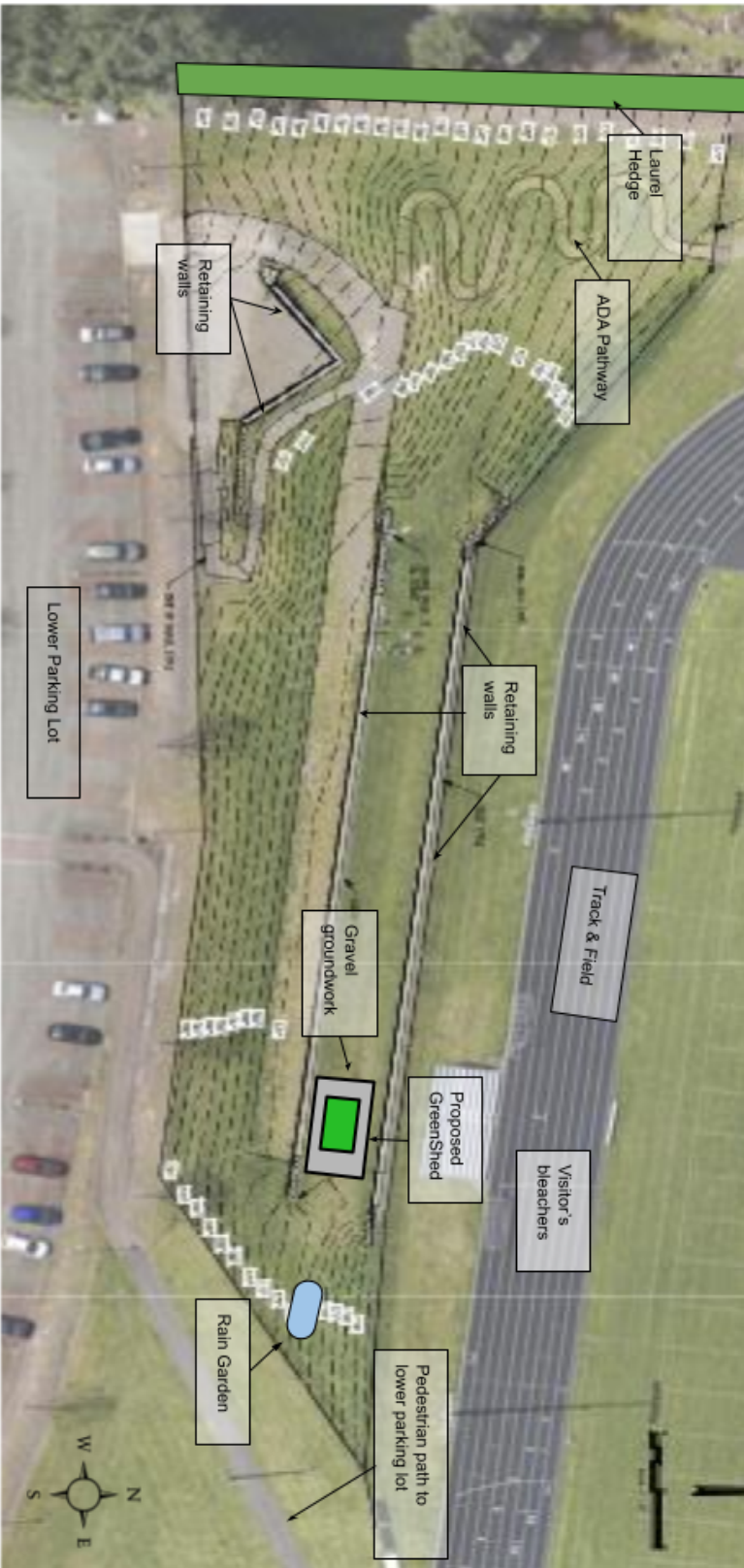

10-3: General Location & Configuration of Proposed Landscaping > La Center Garden

Proposed landscaping at this time - Gravel groundwork and shed construction







#11-1: Existing Exterior Lighting

-  LCHS Stadium lights (existing)
-  Lower parking lot lights (existing)
-  GreenShed (proposed location- no additional lights)



#12-1: Off-street parking and loading facilities

-  Parking lot below the southern boundary of the LCHS Campus- Owned by the City of La Center, used by LCHS during the school day.
-  Proposed GreenShed
-  Utility Road to (proposed) GreenShed and LC Garden from the lower parking lot (south)
-  Access for loading to the GreenShed and LC Garden from the lower parking lot (north)



#13-1: Name & Location & Width of Existing & Proposed On-Site Streets & Roadway Easements

- Parking lot below the southern boundary of the LCHS Campus - Owned by the City of La Center, used by LCHS during the school day.
- Access Utility Road to (proposed) GreenShed and LC Garden from the lower parking lot (south)
- Access for loading to the GreenShed and LC Garden from the lower parking lot (north) Proposed GreenShed
- Proposed GreenShed █

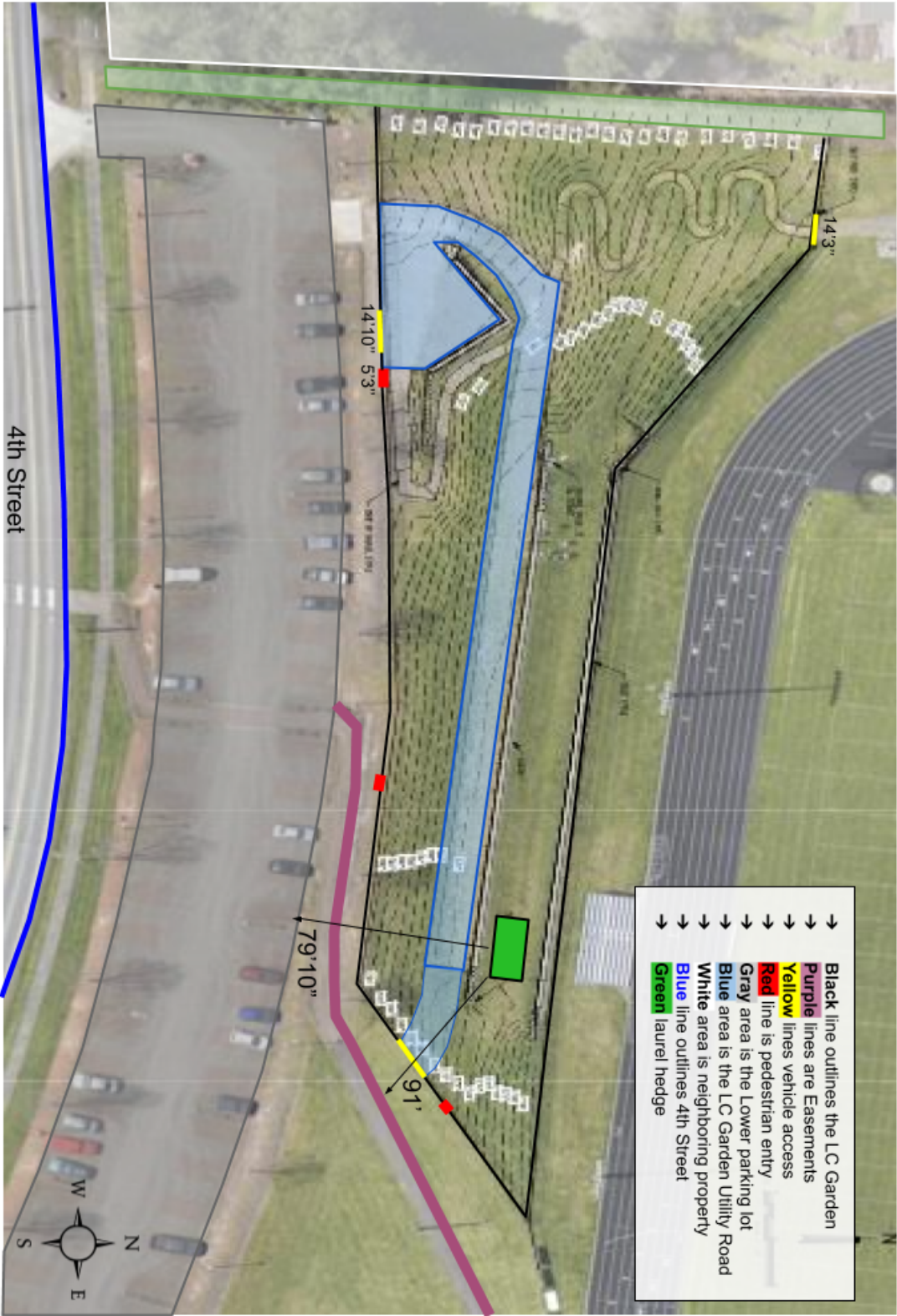

#14-1: Location & Width of Existing & Proposed On-Site Pedestrian & Bicycle Facilities

■ ADA Pathway: 5 feet and 3 inches wide x 239 ft long at 5% grade (existing and proposed)

■ ADA Pathway and Utility Road: 13 feet and 4 inches wide x 74 ft long at 5% grade (existing)

*No additional trails or bicycle facilities are intended to be added for the La Center GreenShed within the LC Garden.

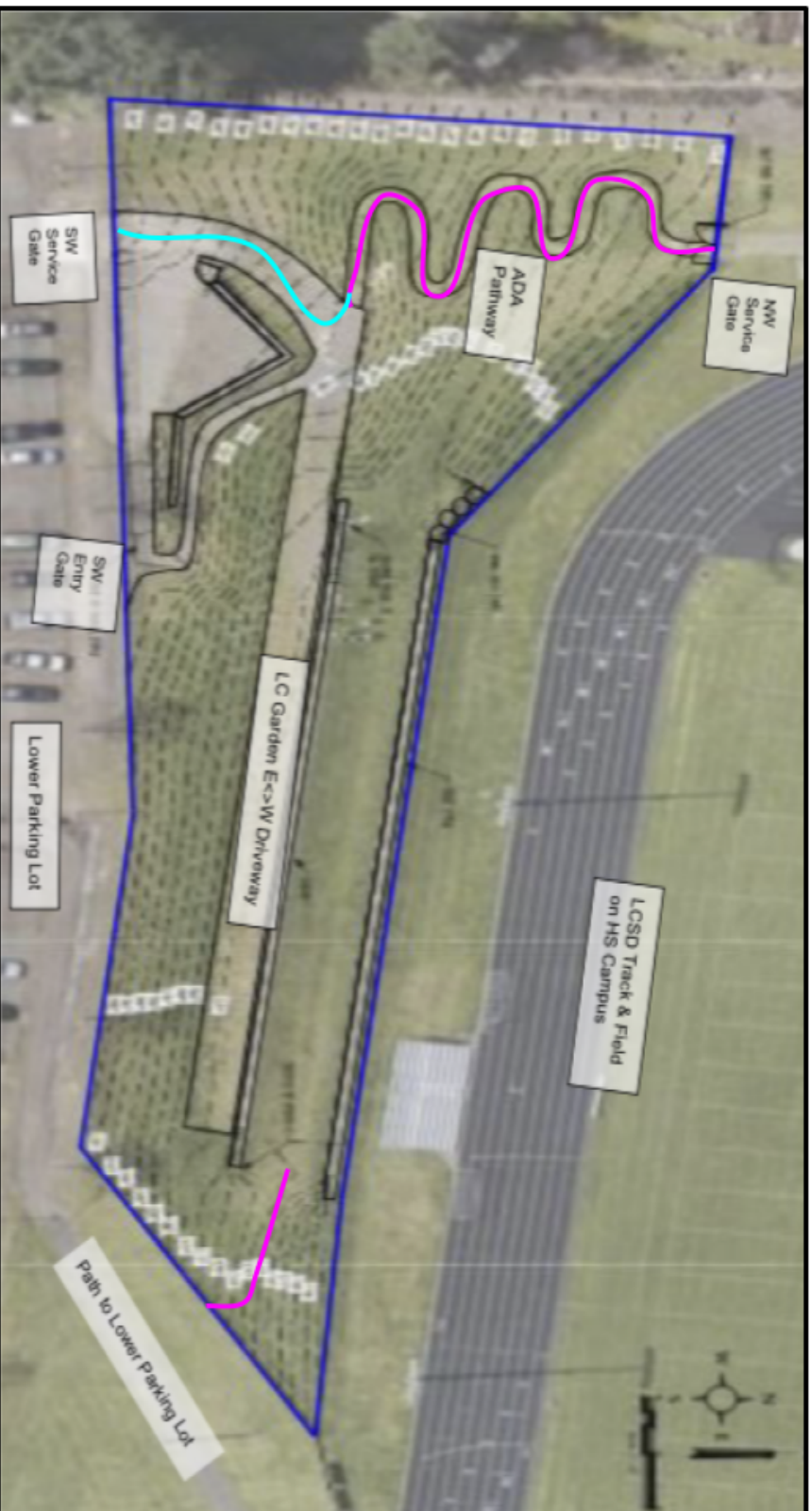

#14-2: Gravel Trail Plan for LC Garden

"Gravel Trail" Designed and drawn by "ALC" on 4/13/16 as a component of the Community Garden La Center School permits for the construction of the La Center Garden - No additional trails have been installed since the 2016 Construction of the Garden.

*No additional trails or bicycle facilities are intended to be added for the La Center GreenShed within the LC Garden.

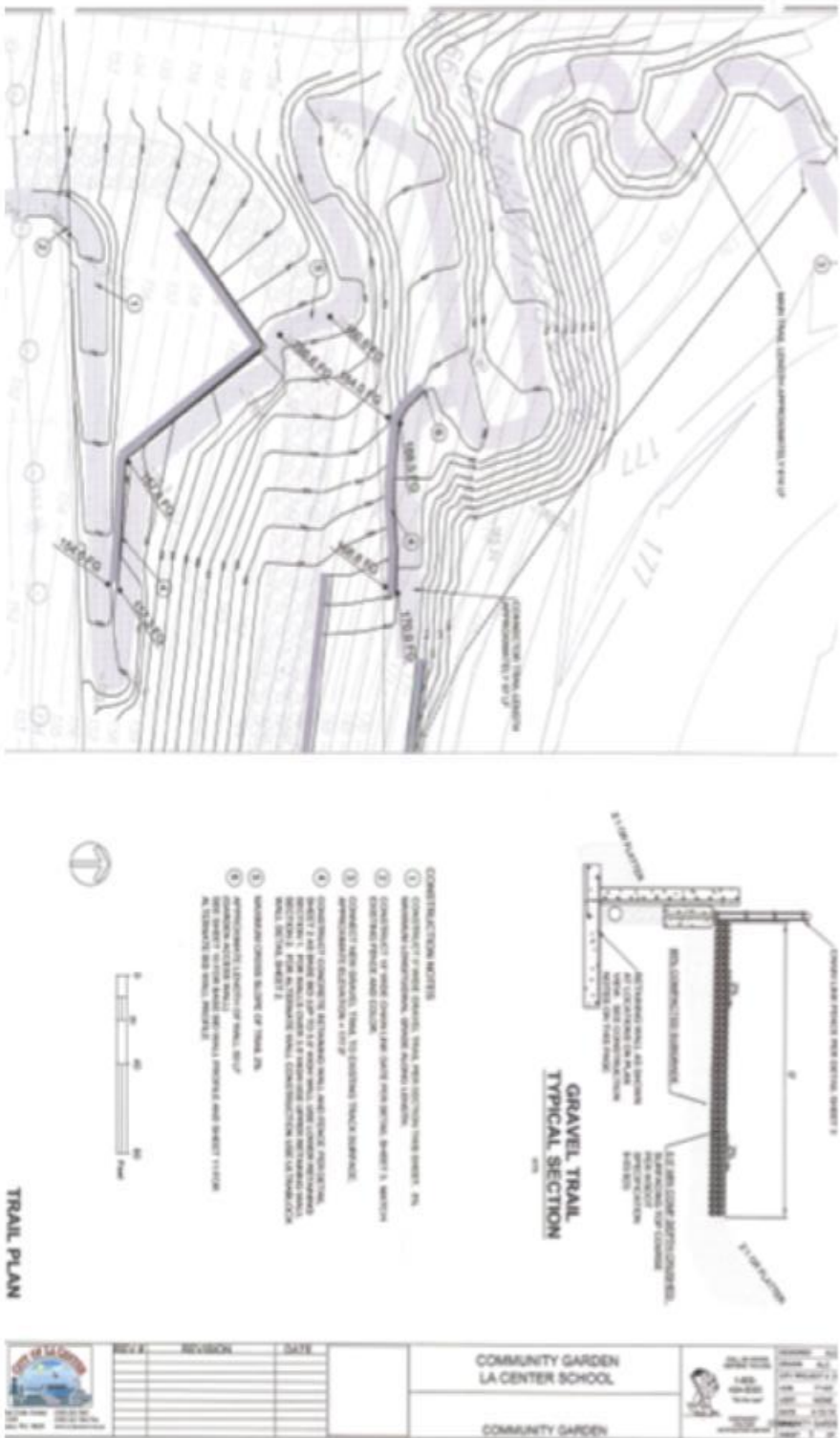

#15-1: Existing & Proposed Public & Private Utilities

- Utility conduits noted below - electrical, water, and gas- Included in previous development of the LC Garden in the Northeastern and North-center areas of the LC Garden (existing)
 - *No current intended utility use for the GreenShed Structure
- Stadium lights to the north (existing) [See doc "#11-1: Existing Exterior Lighting"]
- Parking lot lights to the south (existing) [See doc "#11-1: Existing Exterior Lighting"]

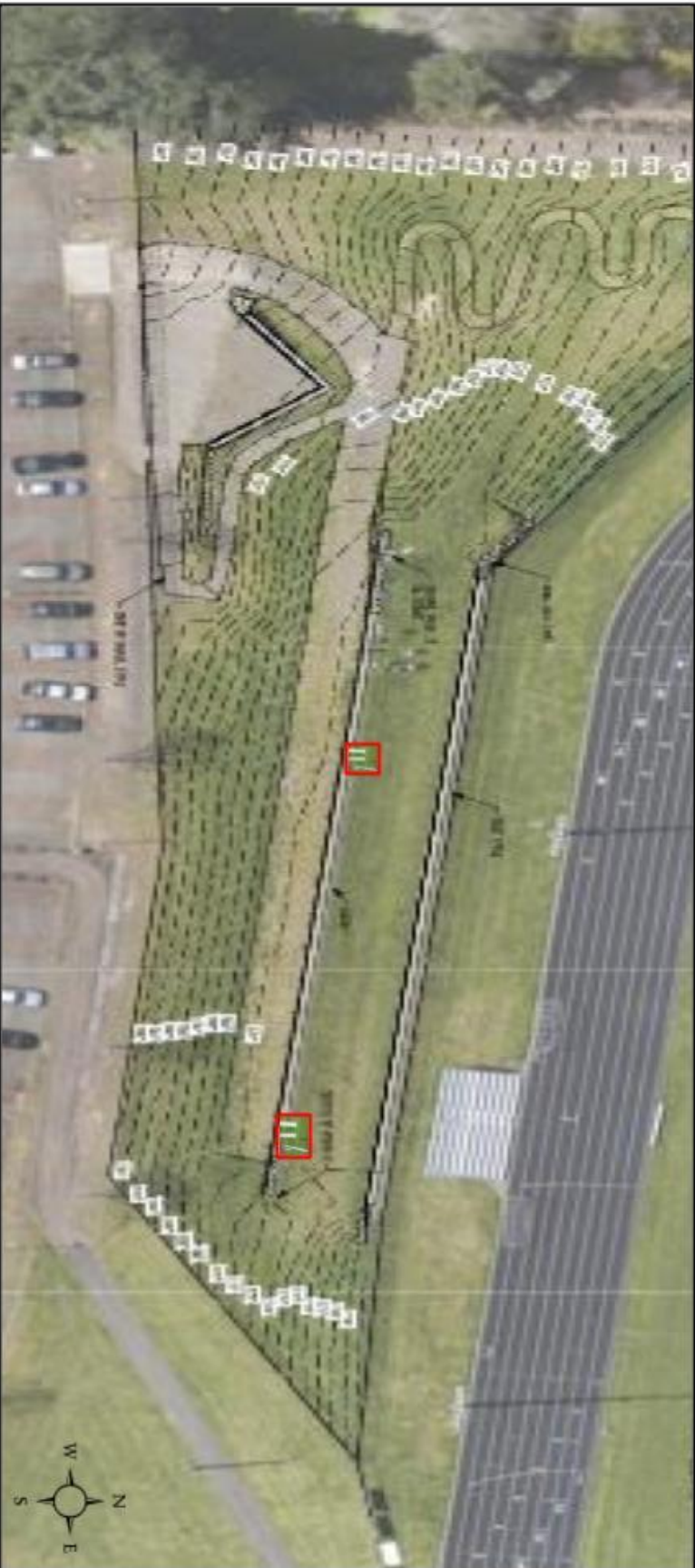

#15-2: Utility Plan for LC Garden

"Utility Plan" Designed and drawn by "ALC" on 4/13/16 as a component of the Community Garden La Center School permits for the construction of the La Center Garden - No additional utilities have been installed since the 2016 Construction of the Garden.
 *No additional utilities will be added at this phase of construction of the La Center GreenShed within the LC Garden.

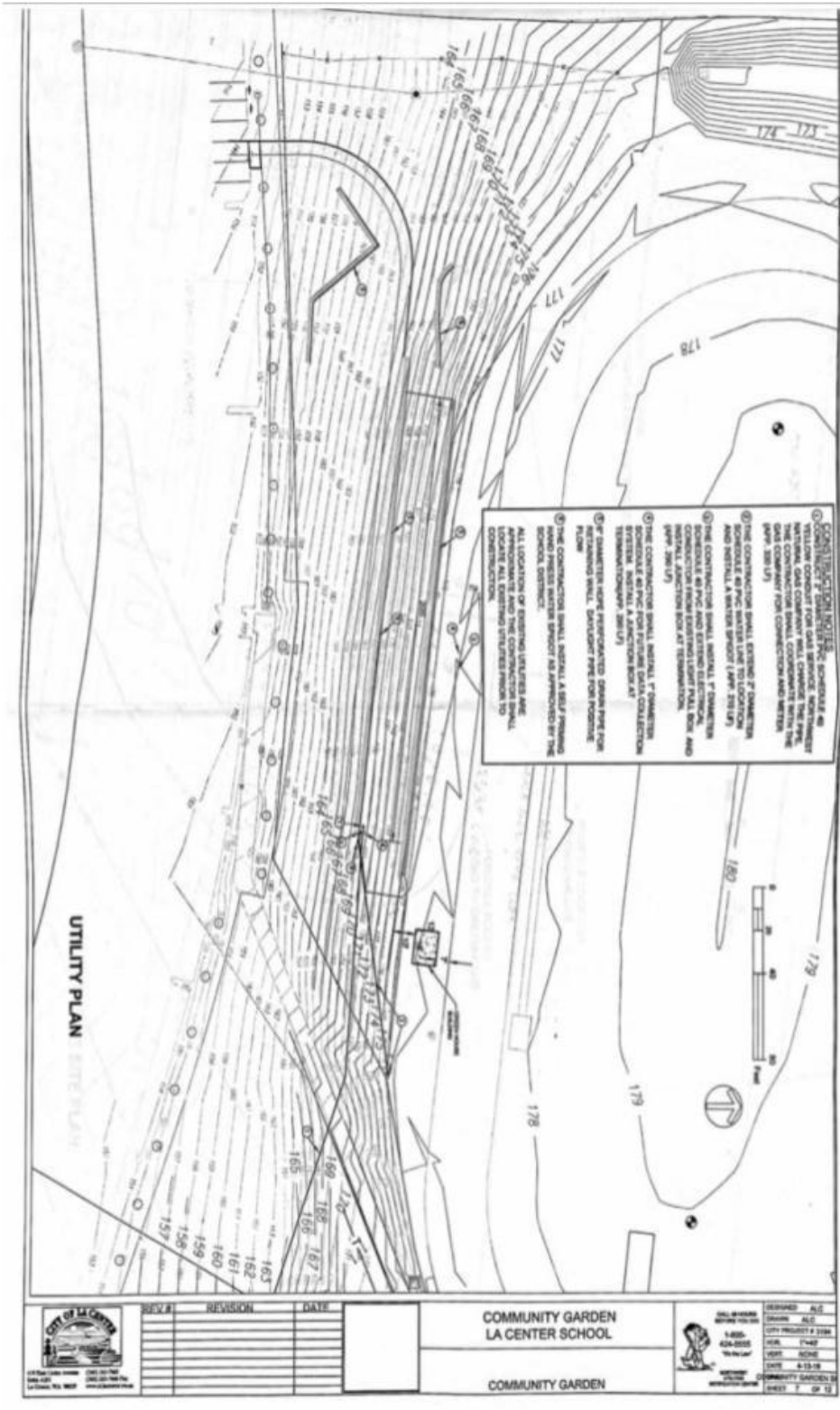

#15-3: Utility Conduit - East and Center

- The picture on the left is of the utility conduits on the Northeastern area of the La Center Garden.
- The picture on the right s of the utility conduits in the North-Center area of the La Center Garden.
- Utility conduits noted below were included in the 2016 development of the LC Garden in the Northeastern and North-center areas of the LC Garden (existing)
- *No current intended utility use for the GreenShed Structure



#16-1: LC Garden Boundaries

<p>Archaeological Probability: <u>medium-high, high</u></p> <p>Archaeological Site Buffer: <u>yes</u></p> <p>Geological Hazard: <u>Areas of Potential Instability Slopes > 15%</u></p> <p>Reference: Clark County Land Records https://gis.clark.wa.gov/ishome/parcelproperty/Reports/?account=622965253</p>	<p>Our GreenShed is to be constructed in the La Center Garden. The LC Garden was permitted to be developed in 2016. Due to the medium-high, high <i>Archaeological Probability</i> we will not be pouring a concrete foundation; instead, we will use a 3-4 inch deep gravel pad as the foundation for our GreenShed.</p>
---	---

