

© CLARK LAND DESIGN, PLLC. DATE PLOTTED: Mar. 28, 2022, 1:58 PM. C:\DRAWING\FILE\DI\DI\PROPOX\PROJECTS\2021\PROJECTS\1.21.048 STEPHENS HILLSIDE FARM REVISED\2022\CAD\01-SHEETS\1.048 PARK PLANNING

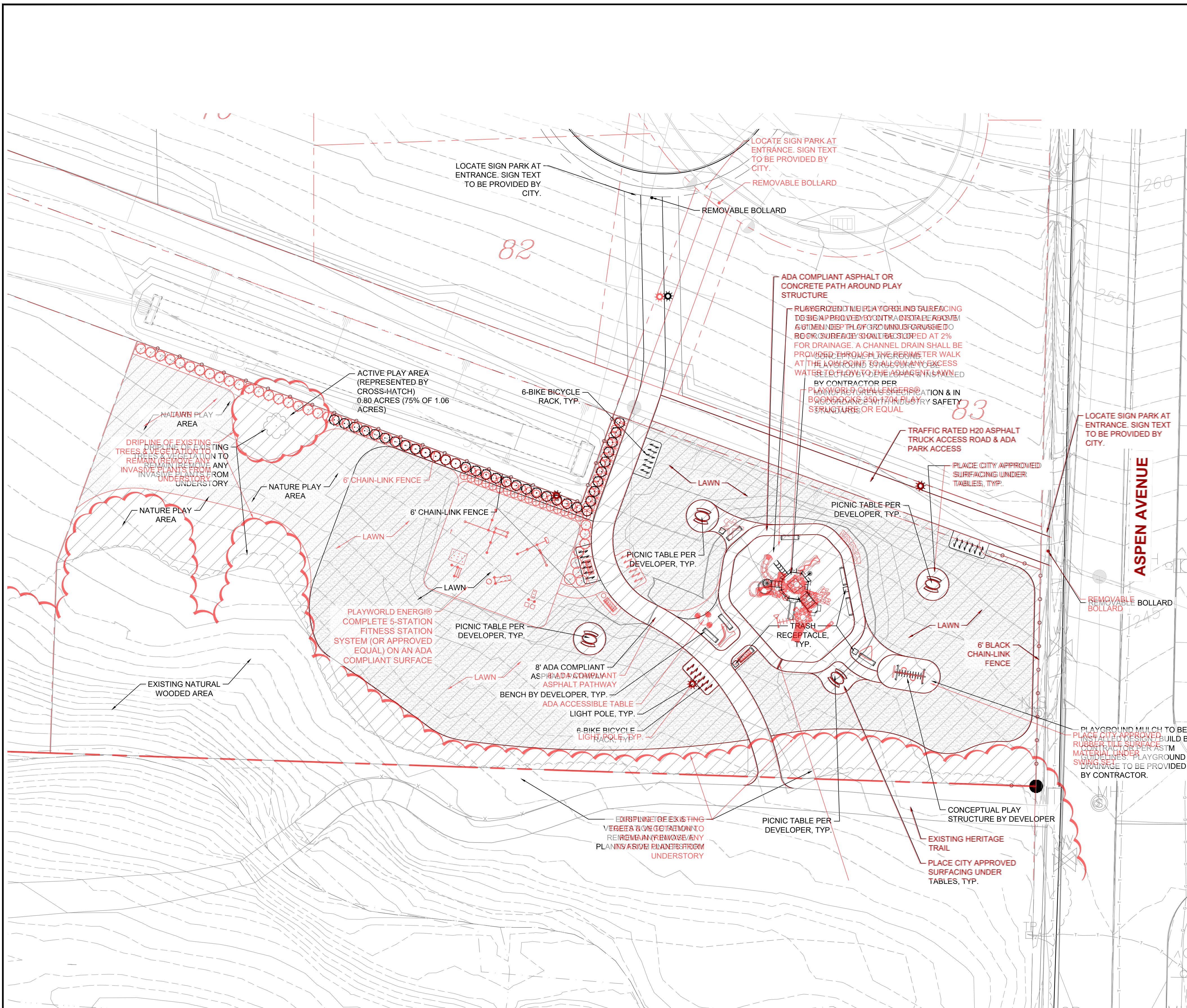

THE DIAGRAM ABOVE IS AN OVERLAY OF THE PARK PLAN FOR THE 2018 PROJECT AND THE 2022 REVISED LAYOUT, SUBMITTED FOR POST DECISION REVIEW. THE RED LINES INDICATE THE IMPROVEMENTS PROPOSED BY THE 2018 PROJECT. THE EXTENT OF THE PARK IMPROVEMENTS ARE REDUCED IN THE 2022 REVISED LAYOUT, SPECIFICALLY IN THE WEST OF THE PARK. AREAS IN THE EAST OF THE PARK WILL REMAIN EXISTING FIELD RATHER THAN IMPROVED WITH LAWN. THE WALKWAY, PICNIC TABLES, BIKE PARKING AND PLAYSTRUCTURE AREA IN THE EAST SECTION ARE UNCHANGED. IMPACTS ARE REDUCED BY THE 2022 LAYOUT. THERE ARE NO ADDITIONAL IMPACTS PROPOSED BY THE 2022 REVISED LAYOUT.

**PLANT SCHEDULE**

SHRUBS	BOTANICAL / COMMON NAME	CONTAINER	SPREAD	SPACING	QTY
☉	Mahonia aquifolium / Tall Oregon Grape	5 gal	18"-24"	4' o.c.	35
SEED	BOTANICAL / COMMON NAME	CONTAINER	SPREAD	SPACING	QTY
☐	Turf Seed PT 755 Fleur de Lawn / Pro-time Fleur de Lawn Seed Mix	seed			18,698 sf

- NOTES:
- ALL AMENITIES AND STRUCTURES ARE SHOWN CONCEPTUALLY. ALL EQUIPMENT WILL BE SELECTED BY THE DEVELOPER AND INSTALLED, DESIGN / BUILD, BY THE CONTRACTOR IN ACCORDANCE WITH INDUSTRY STANDARDS, ASTM GUIDELINES, AND MANUFACTURER'S SPECIFICATIONS.
  - PATHWAYS AND PLAY AREA SHAPES MAY BE ADJUSTED TO ACCOMMODATE AMENITIES, STRUCTURES, EQUIPMENT, AND TOPOGRAPHY.
  - ALL EQUIPMENT LISTED ABOVE SHALL BE AS SPECIFIED OR AN APPROVED EQUAL.
  - BIKE RACKS, TABLES, AND BENCHES SHALL BE PLACED ON AND ANCHORED TO CONCRETE.
  - ACTIVE PLAY AREA IS REPRESENTED BY A CROSS HATCH ON THE PLANS. 0.80 ACRES ARE PROVIDED (75% OF THE 1.06 ACRE PARK).
  - NATURE PLAY AREA TO INCLUDE DEVELOPER CHOSEN IMPROVEMENTS WHICH MAY INCLUDE, BUT ARE NOT LIMITED TO: DIRT OR MULCH TRAILS, LOGS, TUNNELS, BERMS, BOULDERS, NATIVE PLANTINGS, ETC... EXISTING VEGETATION WILL BE RETAINED.

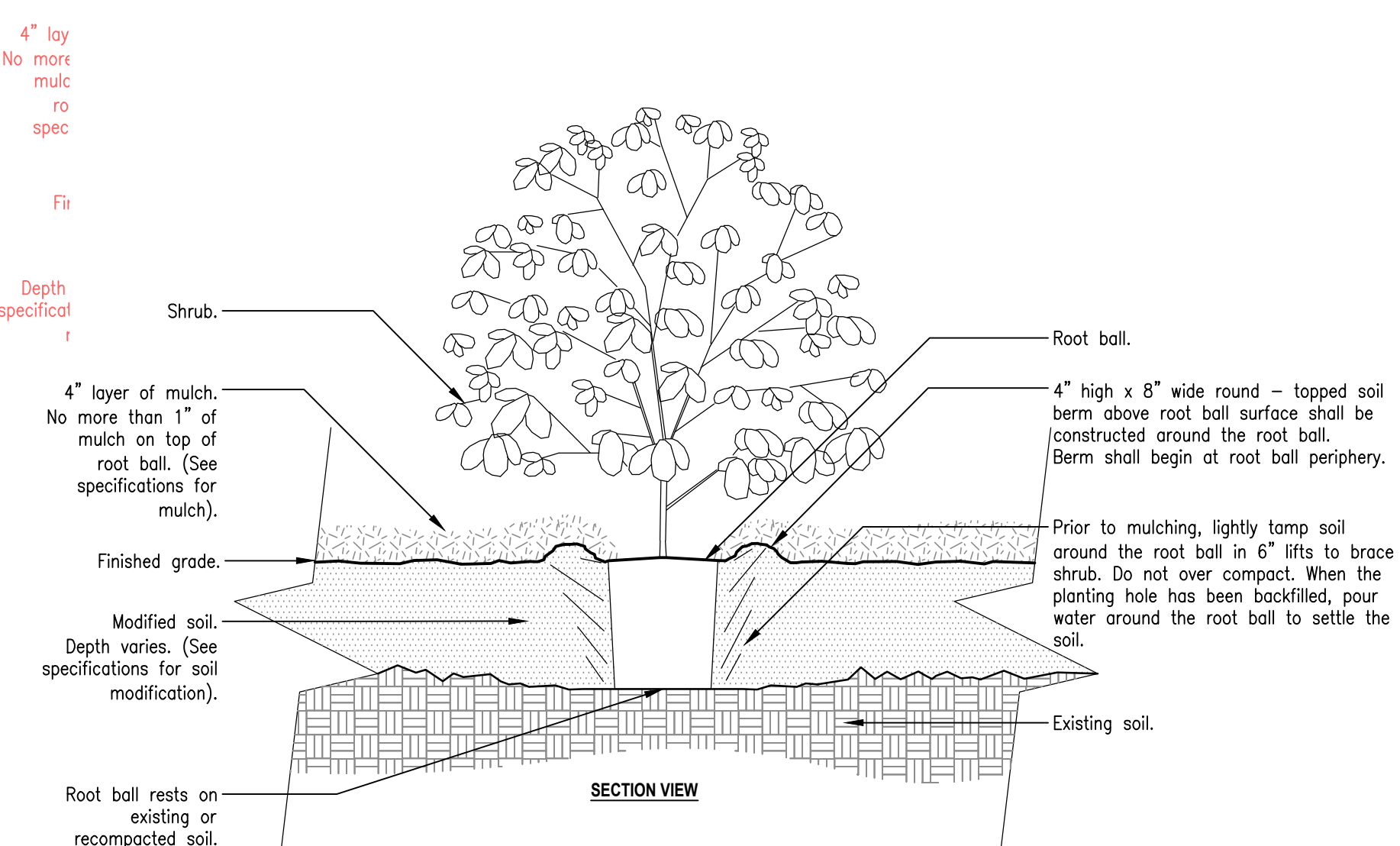

- Notes:
- Shrubs shall be of quality prescribed in the root observations detail and specifications.
  - See specifications for further requirements related to this detail.
- 1 SHRUB - MODIFIED SOIL**  
3/4" = 1'-0"

URBAN TREE FOUNDATION © 2014  
OPEN SOURCE. FREE TO USE  
FX-PL-FX-SHRB-03

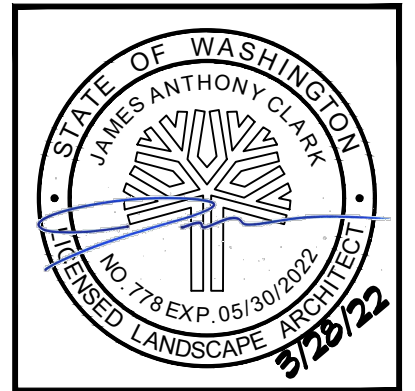
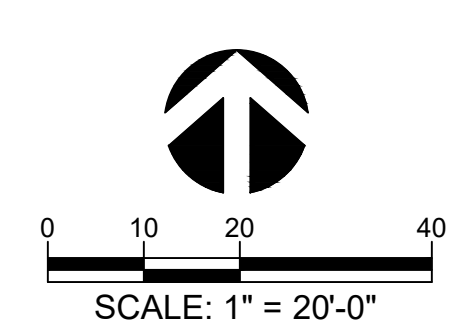

**STEPHENS HILLSIDE FARM SUBDIVISION**  
34700 NE NORTH FORK AVENUE  
LA CENTER, WA 98629



**SHEET TITLE**  
PARK PLAN

**REUSE OF DOCUMENTS**  
This document, and the ideas and designs incorporated, as an instrument of professional service is the property of Clark Land Design, PLLC and is not to be used, in whole or in part, for any reason without the written authorization of Clark Land Design, PLLC.

**DATE** 03/18/2022  
**ISSUE** PERMIT  
**REVISION**

**DRAWN BY** JAC  
**CHECKED BY** JAC

**JOB # :** 1.21.048

**SHEET NUMBER**  
**L1.0**