

Site Plan

Located in the SW $\frac{1}{4}$ of Section 4, T4N, R1E W.M.
La Center, Washington

APPLICANT:
Luke Sasse
9321 NE 72nd Ave Bldg C #7
Vancouver, WA 98665
Ph (360) 907-0226
luke@timberlandinc.com

OWNER:
John & Shanna Vanvessem
149000 NW 15th Avenue
Vancouver, WA 98685

CIVIL ENGINEER:
PLS Engineering
Contact: Travis Johnson, PE
604 W Evergreen Blvd
Vancouver, WA 98660
PH: (360) 944-6519
pm@plsengineering.com

GENERAL NOTES

SITE LOCATION: Southwest quadrant of La Center Road and Paradise Park Road
Parcel #'s: 209708000

Public Water Purveyor = COLC
Public Sewer Purveyor = COLC

Boundary and topographic survey data shown on the plan was prepared by PLS Engineering.

Horizontal Datum:
NAD 83 2011 (2010.00 EPOCH), Washington State Plane, South Zone, U.S. survey feet, derived from RTK ties utilizing the Washington State reference network (WSRN)

Vertical Datum:
NAVD88 derived from RTK ties utilizing the Washington State reference network (WSRN)

SITE STATISTICS		
ZONE: JUNCTION PLAN (JP)		
Existing Site Area	146,501 SQ FT	3.36 AC
Right of Way Dedication	1,293 SQ FT	0.03 AC
Right of Way Vacation	4,269 SQ FT	24.63 AC
Critical Areas	12,348 SQ FT	0.28 AC
Developed Site Area	137,129 SQ FT	3.15 AC
Total Building SF		
Hotel	11,873 SQ FT	
Coffe / Restaurant	6,100 SQ FT	
Total Parking Spaces		
Standard Parking Spaces	131 (1.18/room)	182
Compact Parking Spaces	61 (9.19/1k sq ft)	
Handicap Parking Spaces	6	6

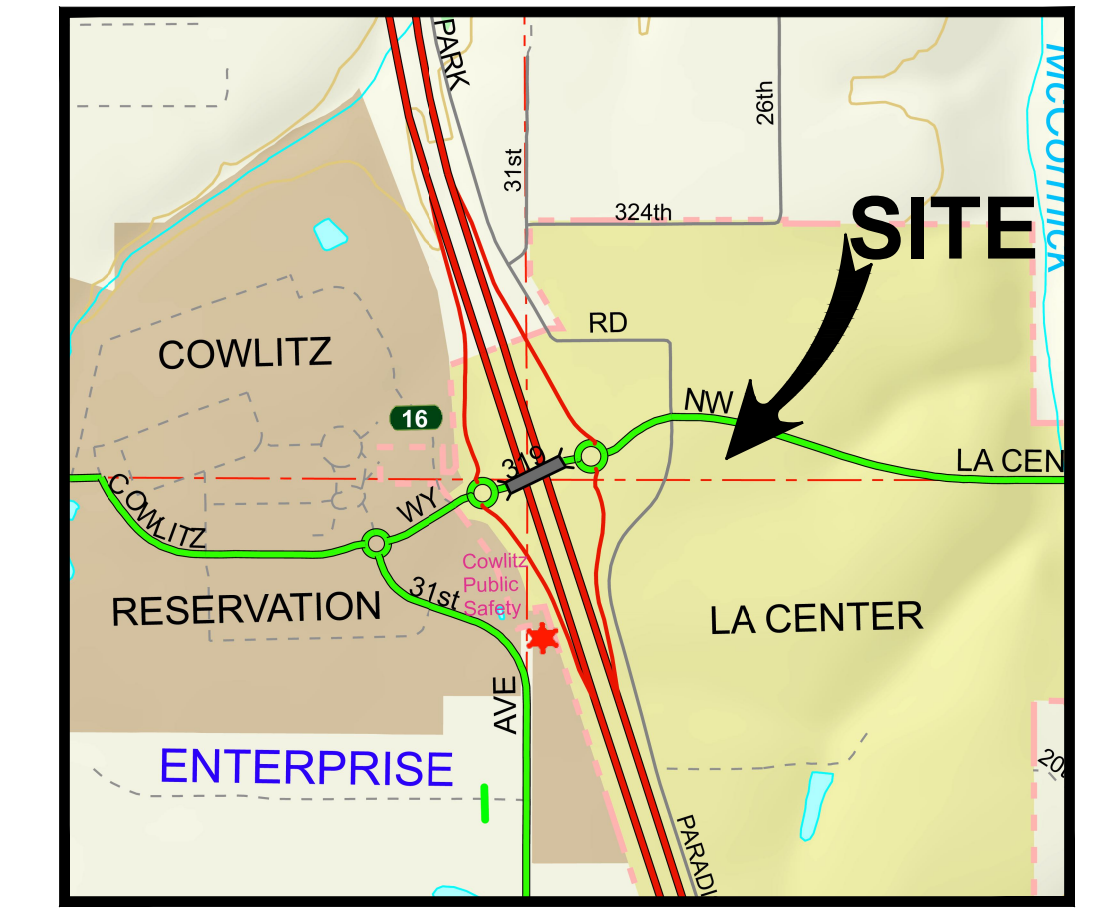

VICINITY MAP
NOT TO SCALE

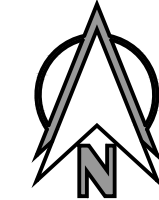
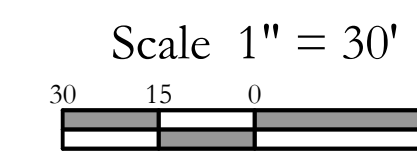

Legend	
Proposed Asphalt Concrete	
Proposed Cement Concrete	

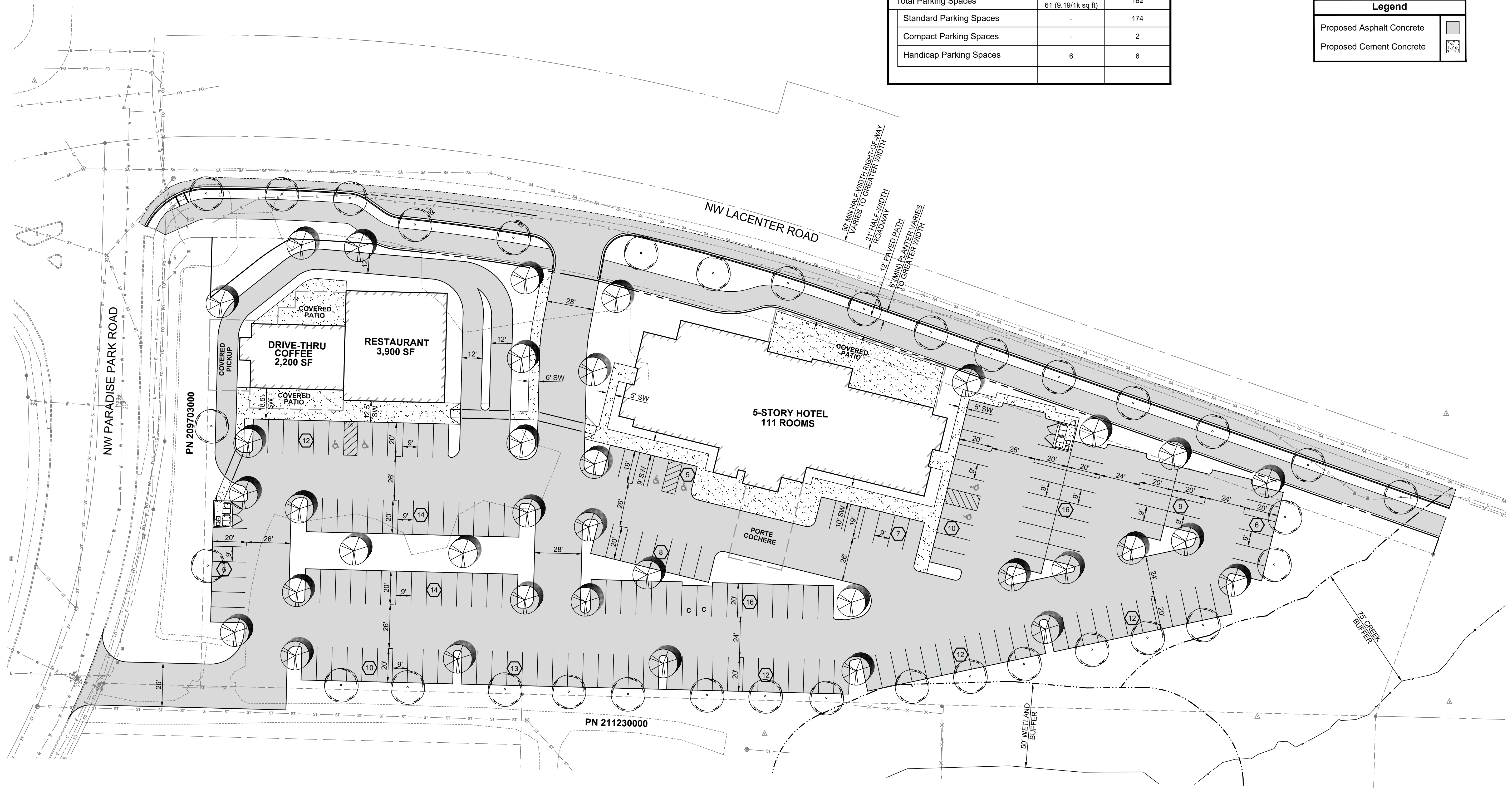

Conceptual Site Plan For:
Site Plan
A Site Located In La Center, Washington

Revisions	
1	
2	
3	
4	
5	
6	

Project No. 3564
SCALE: H: 1" = 30' V: N/A
DESIGNED BY: TGJ
DRAFTED BY: TGJ
REVIEWED BY: TGJ