

**MINISTER-GLAESER
SURVEYING INC.**

2200 E. Evergreen Blvd., Vancouver, Washington 98661
(360) 694-3313 (360) 694-8410 FAX

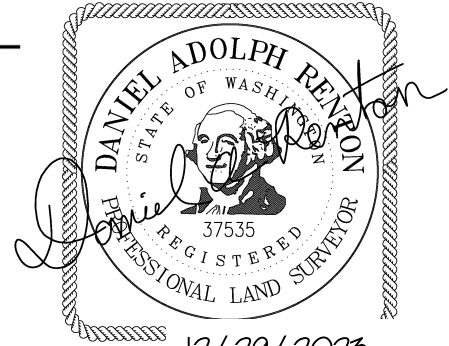

December 20, 2023

**EXHIBIT “ “
PERIMETER PARCEL NUMBER 258895000**

That portion of the Southeast quarter of the Southwest quarter of Section 34, Township 5 North, Range 1 East of the Willamette Meridian, Clark County, Washington, described as follows:

COMMENCING at the Southeast corner of said Southwest quarter of said Section 34, as shown in Plat of Southview Heights Phase IV as recorded in Book J at page 375, records of Clark County;

Thence North $01^{\circ}43'26''$ East along the center line of Section 34, 949.32 feet;

Thence North $88^{\circ}03'16''$ West leaving said center line 54.11 feet to the West right-of-way of Aspen Avenue and **TRUE POINT OF BEGINNING**;

Thence along said right-of-way the following courses and distances;

Thence North $11^{\circ}49'43''$ East, 45.70 feet;

Thence North $01^{\circ}15'46''$ East, 16.85 feet;

Thence North $01^{\circ}17'19''$ East, 53.50 feet;

Thence North $00^{\circ}03'11''$ East, 48.06 feet to the North line of the Parmentier tract as recorded in August 1979 under Clark County Auditor's No. 7908150198;

Thence North $88^{\circ}16'34''$ West along said North line and leaving said West right-of-way, 189.14 feet to the Northwest corner of that tract of land as recorded in November 2006 under Clark County Auditor's No. 4242966 D;

Thence South $01^{\circ}59'09''$ West along West line of said tract, 162.67 feet;

Thence South $88^{\circ}03'16''$ East leaving said West line of tract and along the South line of that tract of land as recorded in June 2021 under Clark County Auditor's No. 5930319 D, 183.81 feet to the **TRUE POINT OF BEGINNING**.

Containing 30,955 square feet, more or less.