

MINISTER-GLAESER SURVEYING INC.

Vancouver Office – 2200 E. Evergreen Blvd., Vancouver, Washington 98661
(360) 694-3313 (360) 694-8410 FAX
Pasco Office – 6303 Burden Blvd. Suite E, Pasco, Washington 99301
(509) 544-7802 (509) 544-7862 FAX

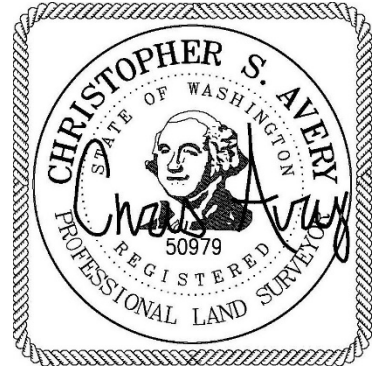

Signed: 06/11/24

EXHIBIT "A"

VALLEY VIEW SUBDIVISION PERIMETER DESCRIPTION:

A portion of LOT 1, of the PERROTT SHORT PLAT as recorded in Book 3 of Short Plats, at Page 905, records of Clark County, being in a portion of Government Lot 2, in the Northwest quarter of the Northeast quarter of Section 2, Township 4 North, Range 1 East, Willamette Meridian, City of La Center, Clark County, Washington described as follows:

COMMENCING at the Northwest corner of the Northwest quarter of the Northeast quarter of Section 2, Township 4 North, Range 1 East;

Thence South $01^{\circ} 49' 22''$ West, 20.00 feet;

Thence South $01^{\circ} 12' 58''$ West, 10.00 feet to the South right of way line of NE 339th street;

Thence South $88^{\circ} 31' 46''$ East, along said South right of way line, parallel with the North line of said Northwest quarter of the Northeast quarter, 427.20 feet;

Thence continuing along said right of way South $88^{\circ} 01' 48''$ East, 20.31 feet to the **TRUE POINT OF BEGINNING** of the following described tract;

Thence continuing along said right of way line, South $88^{\circ} 01' 48''$ East, 820.36 feet;

Thence South $43^{\circ} 06' 33''$ East, 25.00 feet to the West right-of-way line of NE 24th Avenue;

Thence South $01^{\circ} 48' 41''$ West along said right-of-way line and parallel with the East line of said Northwest quarter of the Northeast quarter 462.08 feet;

Thence North $88^{\circ} 11' 19''$ West, 548.00 feet;

Thence North $1^{\circ} 48' 38''$ East, 92.00 feet;

Thence North $88^{\circ} 11' 19''$ West, 290.00 feet;

Thence North 1° 48' 38" East, 390.05 feet to the **TRUE POINT OF BEGINNING**.

TOGETHER with and **SUBJECT** to easements, reservations, covenants, and restrictions apparent or of record.

CONTAINING: 8.635 acres of land.